

D47

S47



General Use Industrial

FLOATING BALL

DIVERTER
SIDE ENTRY - 3 PIECE

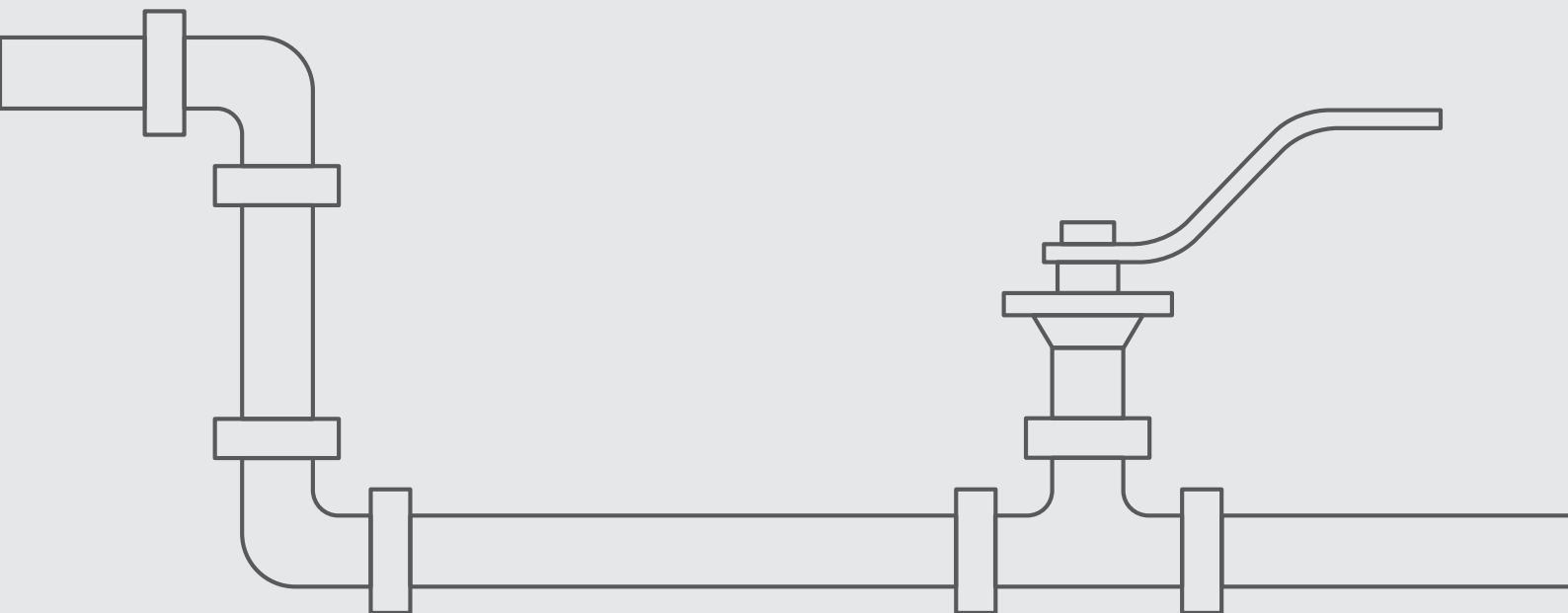

D47

S47

Diverter | Side Entry

Design features

Body

- Three piece design
- Forged or cast body
- Full compliance with ASME B16.34 (wall thickness)
- Easy in-line serviceable with swing-out body
- Large range of end connections for full or standard port valves
- Rugged top mounting platform compliant with ISO 5211 for easy mounting of actuator and other accessories

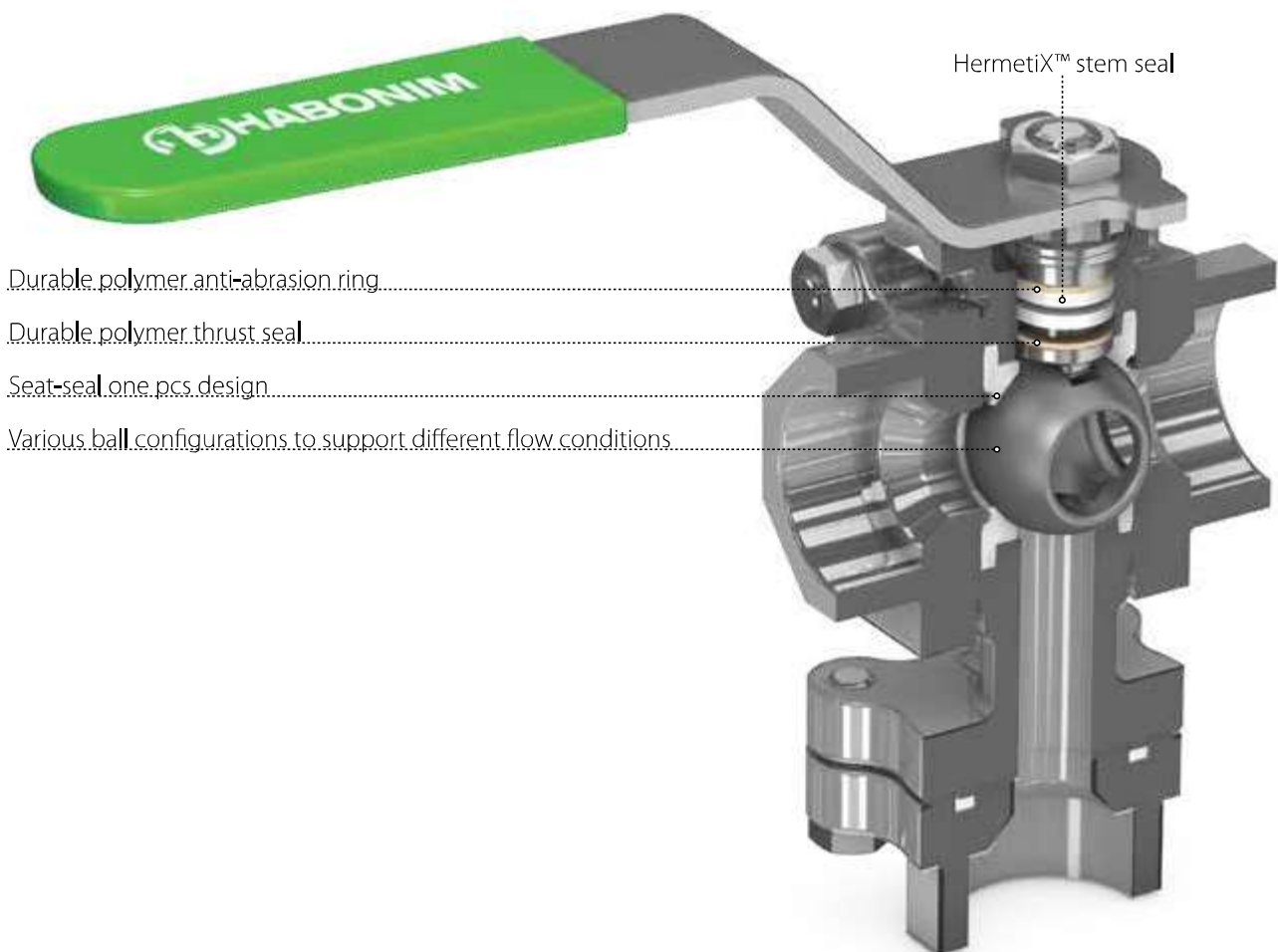



Side Entry - S47

Rotation: 90°

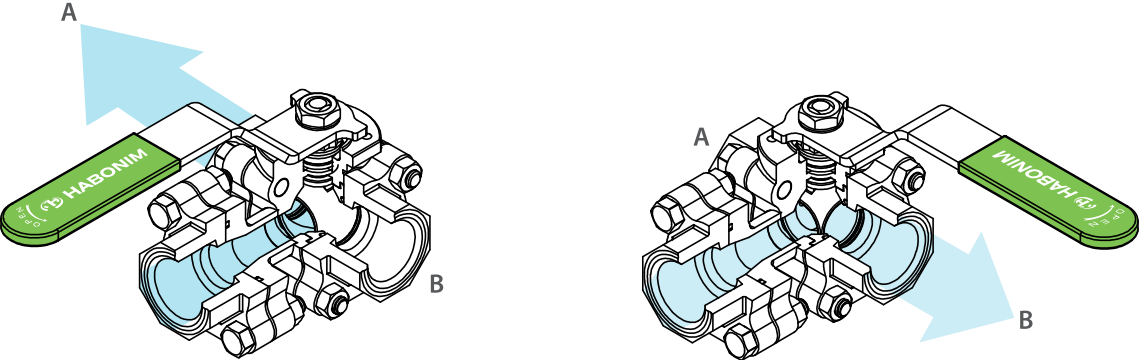

Bottom Entry - D47

Rotation: 90°

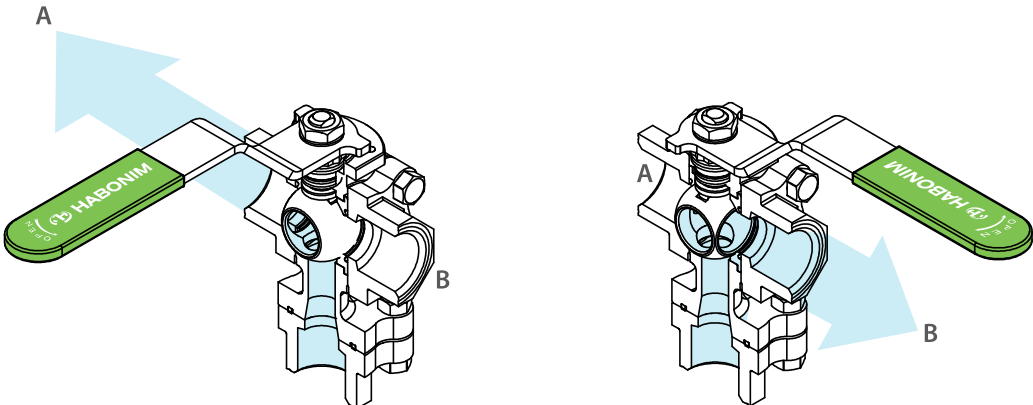

Bottom Entry - D47

Rotation: 180°

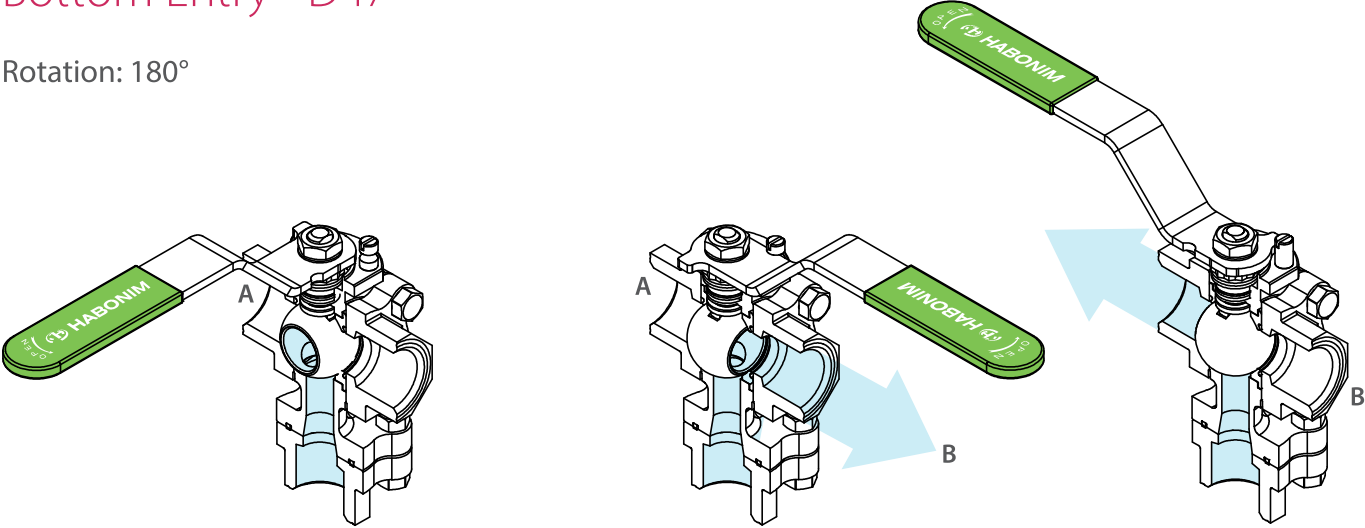

Diverter Floating Ball 3 Piece

Valve dimensions

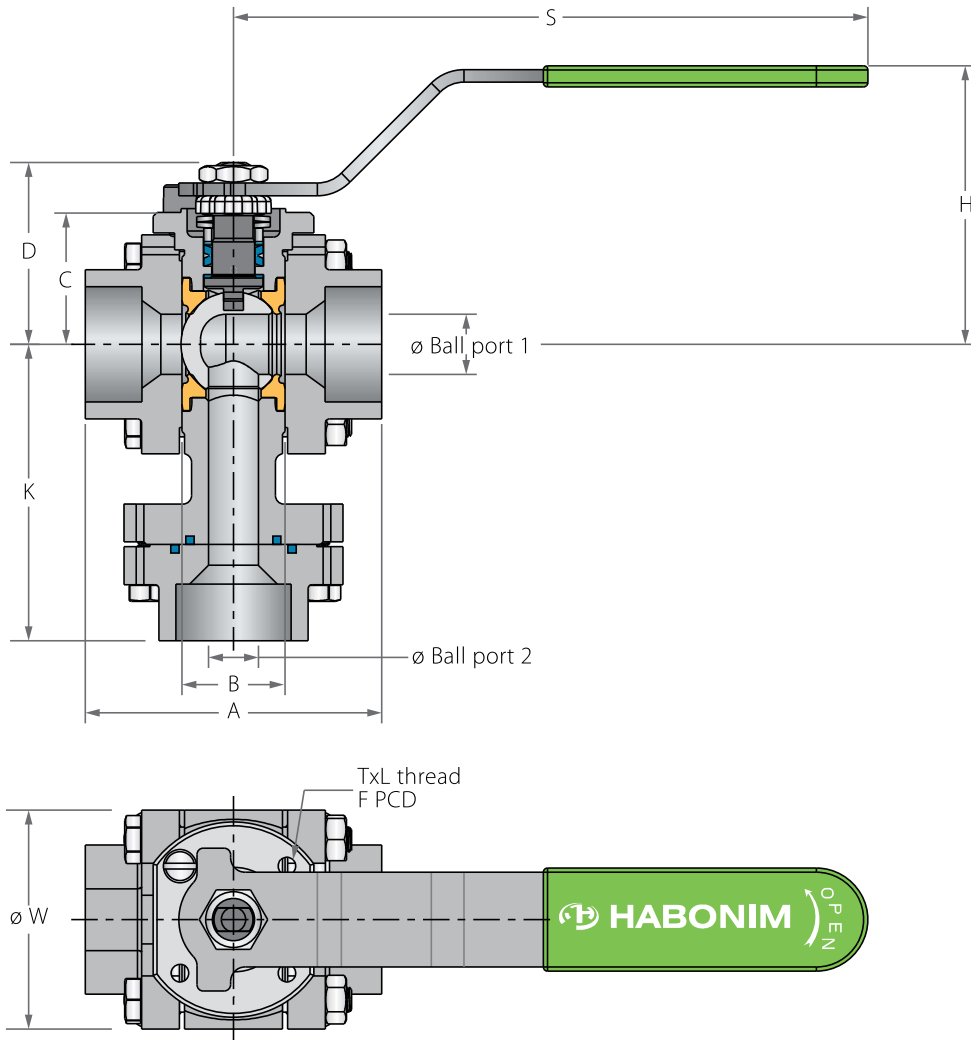

Preparation for actuation

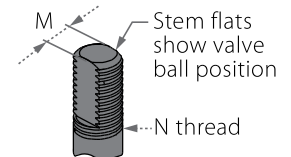
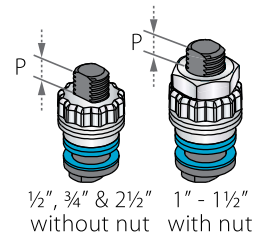

Std. port	Full port	Unit	Ball port1	Ball port2	A	B	C	D	H	K	S	W	M	N	P	F	TxL	Weight kg/lb	Kv Cv
	DN8	mm	10.50	9.50	66.00	20.60	29.00	37.90	61.50	88.20	150.00	47.00	5.54	3/8 UNF	6.65 (F03)	36.00	M5X10	1.00	2.4
	1/4"	inch	0.41	0.37	2.60	0.81	1.14	1.49	2.42	3.48	5.91	1.85	0.22		0.26	1.42		2.20	2.8
DN15	DN10	mm	10.50	9.50	66.00	20.60	29.00	37.90	61.50	88.20	150.00	47.00	5.54	3/8 UNF	6.65 (F03)	36.00	M5X10	1.00	2.8
	1/2"	3/8"	inch	0.41	0.37	2.60	0.81	1.14	1.49	2.42	3.48	5.91	1.85		0.22	0.26		1.42	2.20
DN20	DN15	mm	14.30	11.90	70.60	24.50	31.40	40.30	63.90	93.70	150.00	53.70	5.54	3/8 UNF	6.65 (F03)	36.00	M5X10	1.20	4
	3/4"	1/2"	inch	0.56	0.47	2.78	0.97	1.24	1.59	2.52	3.68	5.91	2.11		0.22	0.26		1.42	2.64
DN25	DN20	mm	20.60	15.90	93.70	31.70	38.10	55.60	79.40	119.00	187.00	63.70	7.54	7/16 UNF	7.40 (F04)	42.00	M5X10	2.40	8
	1"	3/4"	inch	0.81	0.63	3.69	1.25	1.50	2.19	3.13	4.68	7.36	2.51		0.30	0.29		1.65	5.29
DN32	DN25	mm	25.40	20.50	108.00	41.30	42.70	60.20	84.10	130.15	187.00	71.70	7.54	7/16 UNF	7.40 (F04)	42.00	M5X10	4.00	16
	1 1/4"	1"	inch	1.00	0.81	4.25	1.62	1.68	2.37	3.31	5.13	7.36	2.82		0.30	0.29		1.65	8.82
DN40	DN32	mm	31.80	26.60	115.50	48.40	43.60	73.00	97.00	139.05	237.00	86.70	8.71	3/8 UNF	8.50 (F05)	50.00	M6X12	5.50	40
	1 1/2"	1 1/4"	inch	1.25	1.05	4.55	1.91	1.72	2.87	3.82	5.47	9.33	3.41		0.34	0.33		1.97	12.12
DN50	DN40	mm	38.10	35.00	128.00	56.30	48.30	77.80	101.80	149.45	237.00	96.90	8.71	3/8 UNF	8.50 (F05)	50.00	M6X12	6.90	42
	2"	1 1/2"	inch	1.50	1.38	5.04	2.22	1.90	3.06	4.01	5.88	9.33	3.82		0.34	0.33		1.97	15.21
DN65	DN50	mm	50.80	48.00	158.00	72.60	70.00	88.10	115.10	175.40	237.00	108.00	8.71	3/8 UNF	13.50 (F07)	70.00	M8X12	14.45	96
	2 1/2"	2"	inch	2.00	1.89	6.22	2.86	2.76	3.47	4.53	6.90	9.33	4.25		0.34	0.53		2.76	31.85



Diverter Floating Ball 3 Piece

Components & materials

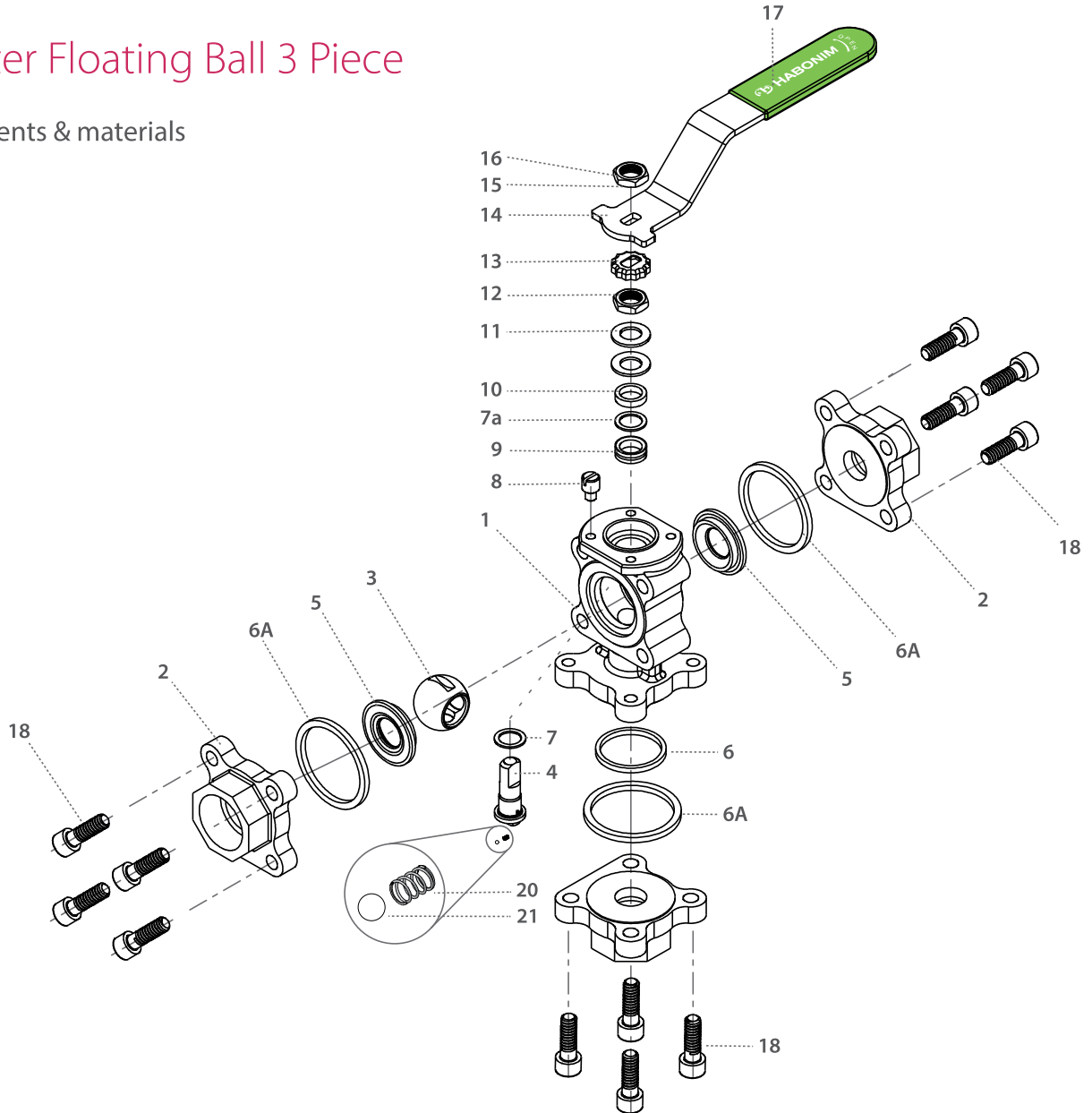

Item	Description	Material specification	Qty.
1	Body	Acc. Ordering Code	1
2	Ends	Acc. Ordering Code	3
3	Ball	Acc. Ordering Code	1
4	Stem	Acc. Ordering Code	1
5*	Seat	Acc. Ordering Code	2
6*	Body seal ⁽¹⁾	Acc. Ordering Code	1
6A*	Outher seal	Acc. Ordering Code	2
7*	Stem thrust seal	PEEK, CF PEEK, PCTFE	1
7a**	Anti-abrasion ring	PEEK, CF PEEK, PCTFE	1
8	Stop pin	S. Steel	1
9*	Stem seal	CF PTFE, TFM	1

⁽¹⁾ One body seal is used in case of Seat-Seal one piece construction (item #5), otherwise three body seals are used

⁽²⁾ 2 1/2" (DN65) size maximum pressure rating is Class 400.

Item	Description	Material specification	Qty.
10	Follower	S. Steel	1
11	Disc spring	S. Steel	2
12	Stem nut	S. Steel	1
13	Locking clip	S. Steel	1
14	Handle	S. Steel	1
15	Serrated washer	S. Steel	1
16	Handle nut	S. Steel	1
17	Sleeve	PVC	1
18	Body bolt	S. Steel	12
20	Anti-static spring	S. Steel	1
21	Anti-static plunger	S. Steel	1
23	Tag (not shown)	S. Steel	1

* Repair kit components

Diverter Floating Ball 3 Piece

Valve dimensions

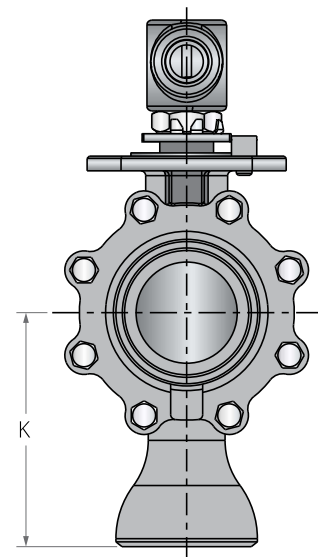
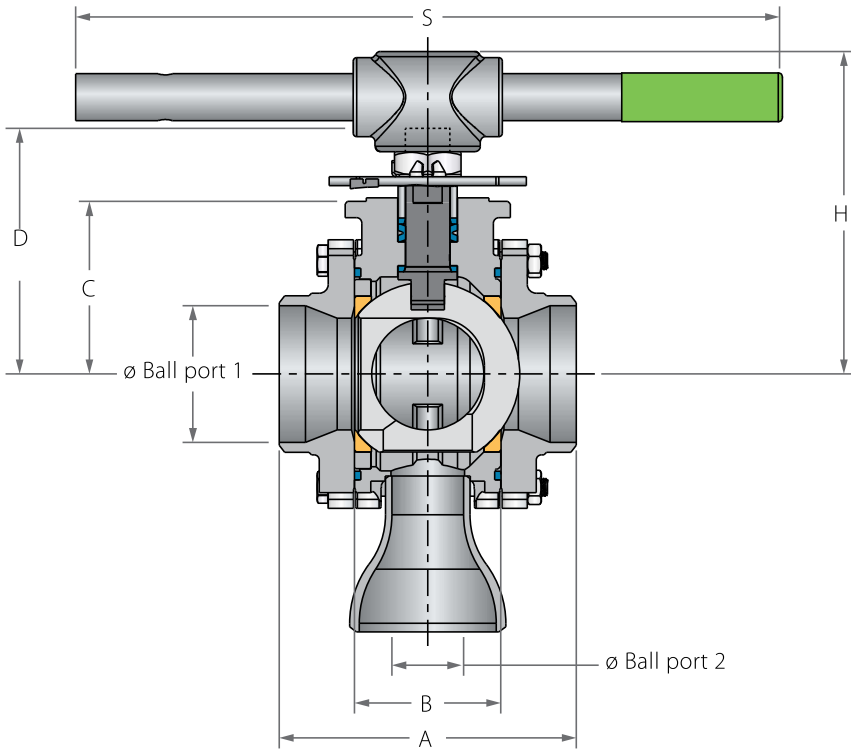

Preparation for actuation

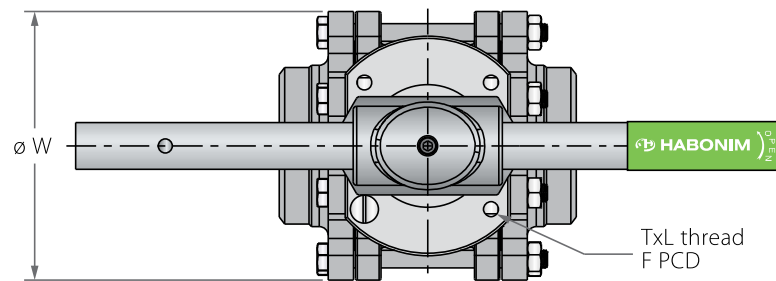
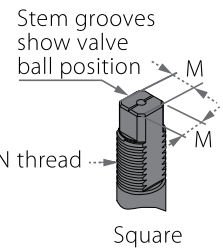
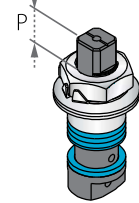

Std. port	Full port	Unit	Ball port 1	Ball port 2	A	B	C	D	H	K	S	W	M	N	P	F	TxL	Weight kg/lb	Kv Cv
DN80	DN65	mm	63.75	80.50	169	83.3	98.3	144.9	185	163	400	18.90	15.90	1"-14	16.70 (F10)	102.00	M10x20	18.00	129
3"	2½"	inch	2.51	3.17	6.65	3.28	3.87	5.70	7.28	6.42	15.75	0.74	0.63	UNS-2A	0.66	4.02	M10x20	39.67	150
DN100	DN80	mm	80.00	63.25	214	108.8	114.1	160.7	200	183	600	18.90	15.90	1"-14	16.70 (F10)	102.00	M10x20	28.20	182
4"	3"	inch	3.15	2.49	8.43	4.28	4.49	6.33	7.87	7.20	23.62	0.74	0.63	UNS-2A	0.66	4.02	M10x20	62.15	211
	DN100	mm	92.00	67.00	239	123	124	170.5	211	200	600	18.90	15.90	1"-14	16.70 (F10)	102.00	M10x20	36.00	334
	4"	inch	3.62	2.64	9.41	4.84	4.88	6.71	8.31	7.87	23.62	0.74	0.63	UNS-2A	0.66	4.02	M10x20	79.34	388
DN150		mm	111.35	77.90	346	146	157	226	286	212	916	28.45	23.75	1½"-12	26.20 (F12)	125.00	M12x20	41.00	437
6"		inch	4.38	3.07	13.62	5.75	6.18	8.90	11.26	8.35	36.06	1.12	0.94	UNF-2A	1.03	4.92	M12x20	90.36	507



Diverter Floating Ball 3 Piece

Components & materials

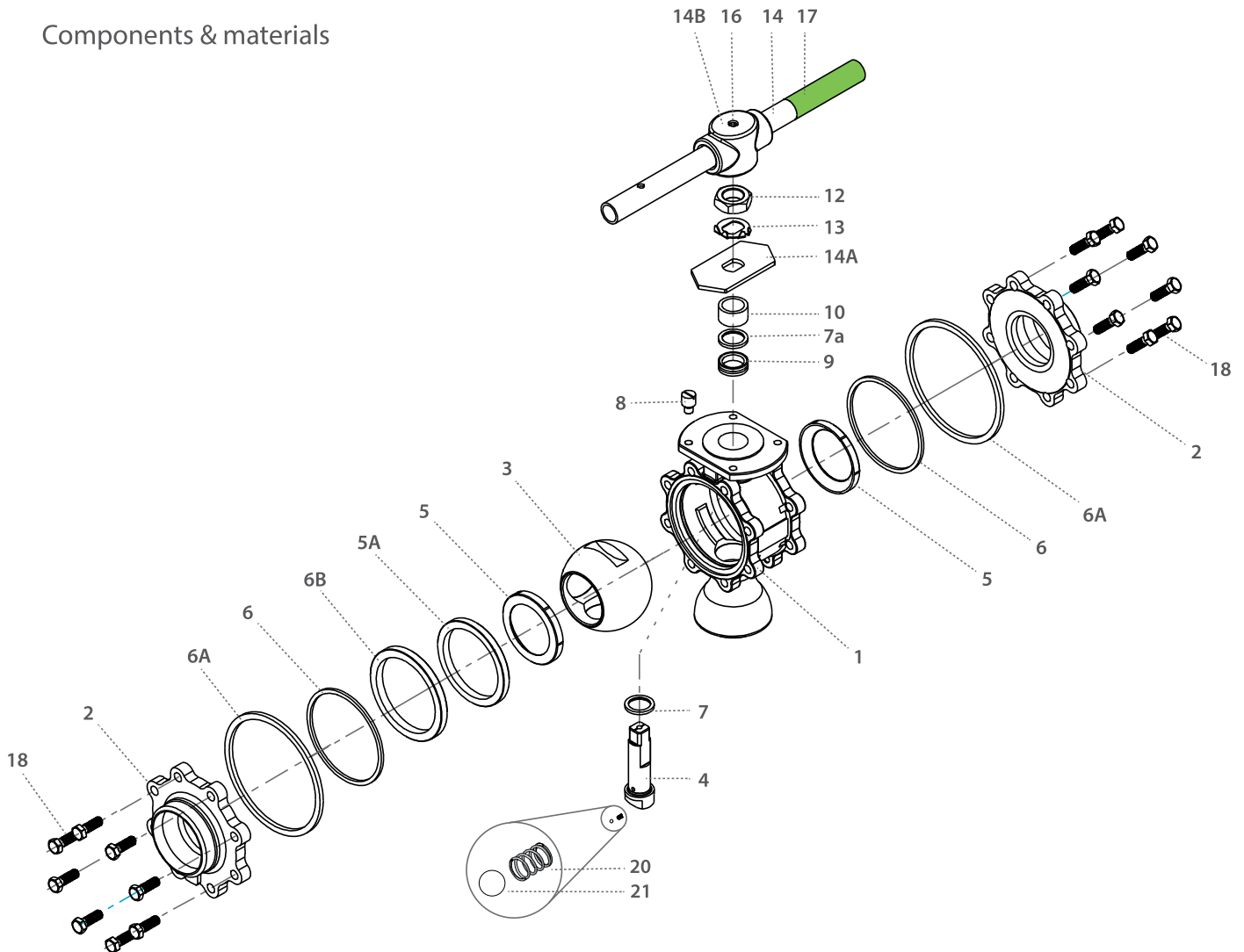

Item	Description	Material specification	Qty.
1	Body	Acc. Ordering Code	1
2	Plug	Acc. Ordering Code	1
3	Ball	Acc. Ordering Code	1
4	Stem	Acc. Ordering Code	1
5*	Seat	Acc. Ordering Code	2
6*	Body seal	Acc. Ordering Code	1
6A*	Outer seal	Acc. Ordering Code	
6B	Support ring	S. Steel	
7*	Stem thrust seal	PEEK, CF PEEK, PCTFE (KEL-F)	1
7a	Anti-abrasion ring	PEEK, CF PEEK, PCTFE (KEL-F)	1
8	Stop pin	S. Steel	1
9*	Stem seal	CF PTFE, TFM	1
10	Follower	S. Steel	1

Item	Description	Material specification	Qty.
11	Disc spring	S. Steel	2
12	Stem nut	S. Steel	1
13	Tab lock washer	S. Steel	1
14	Handle	S. Steel	1
14A	Stop plate	S. Steel	1
14B	Wrench head	S. Steel	1
16	Wrench bolt	S. Steel	1
17	Sleeve	PVC	1
18	Body bolt	S. Steel	16
20	Anti-static spring	S. Steel	2
21	Anti-static plunger	S. Steel	2
23	Tag (not shown)	S. Steel	1

* Repair kit components

Side Entry Floating Ball 3 Piece

Valve dimensions

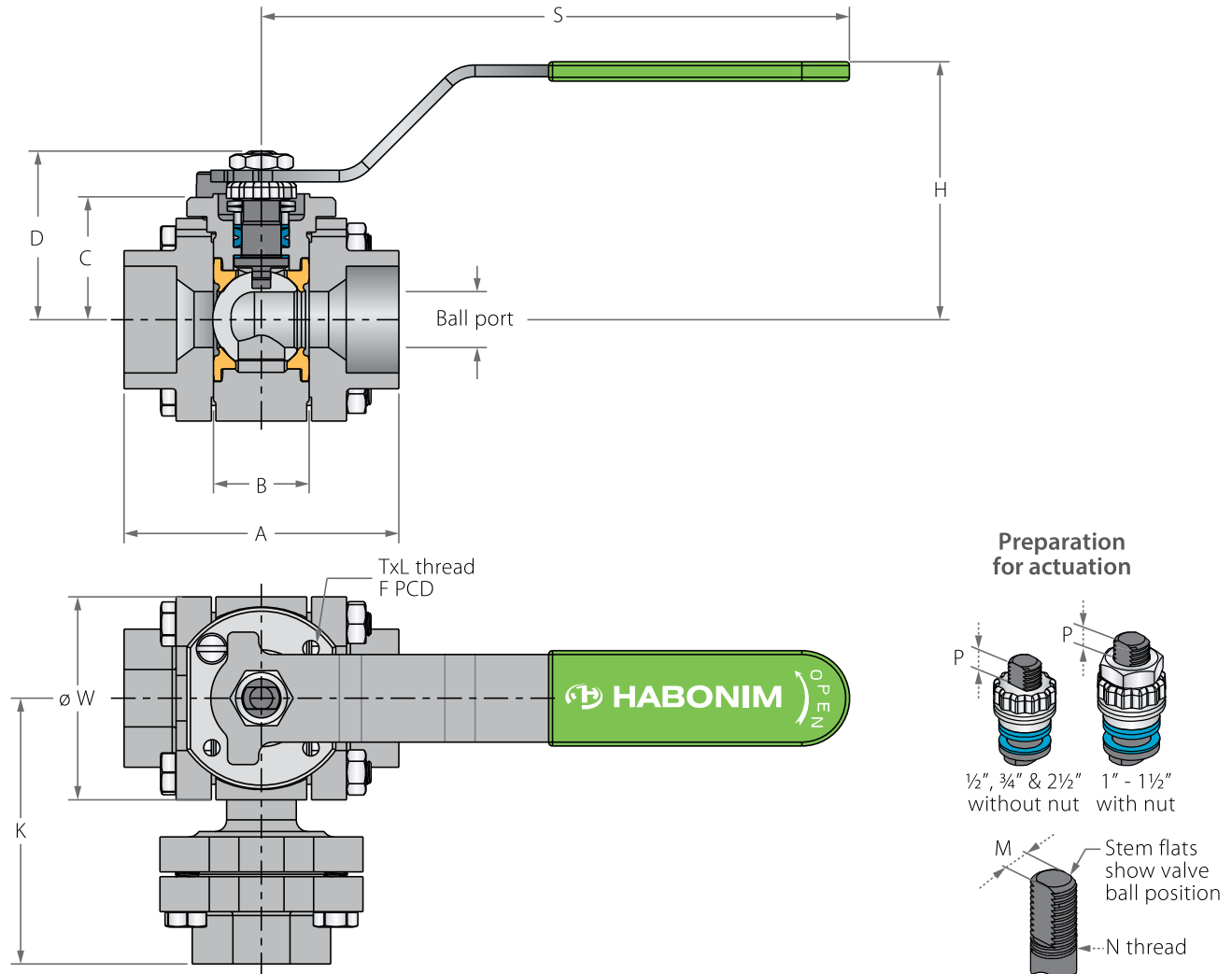

Std. port	Full port	Unit	Ball port1	Ball port2	A	B	C	D	H	K	S	W	M	N	P	F	TxL	Weight kg/lb	Kv Cv
	DN8	mm	10.50	9.50	66.00	20.60	29.00	37.90	61.50	88.20	150.00	47.00	5.54	3/8 UNF	6.65 (F03)	36.00	M5X10	1.00	2.4
	1/4"	inch	0.41	0.37	2.60	0.81	1.14	1.49	2.42	3.48	5.91	1.85	0.22		0.26	1.42		2.20	2.8
DN15	DN10	mm	10.50	9.50	66.00	20.60	29.00	37.90	61.50	88.20	150.00	47.00	5.54	3/8 UNF	6.65 (F03)	36.00	M5X10	1.00	2.8
1/2"	3/8"	inch	0.41	0.37	2.60	0.81	1.14	1.49	2.42	3.48	5.91	1.85	0.22		0.26	1.42		2.20	3.3
DN20	DN15	mm	14.30	11.90	70.60	24.50	31.40	40.30	63.90	93.70	150.00	53.70	5.54	3/8 UNF	6.65 (F03)	36.00	M5X10	1.20	4
3/4"	1/2"	inch	0.56	0.47	2.78	0.97	1.24	1.59	2.52	3.68	5.91	2.11	0.22		0.26	1.42		2.64	5
DN25	DN20	mm	20.60	15.90	93.70	31.70	38.10	55.60	79.40	119.00	187.00	63.70	7.54	7/16 UNF	7.40 (F04)	42.00	M5X10	2.40	8
1"	3/4"	inch	0.81	0.63	3.69	1.25	1.50	2.19	3.13	4.68	7.36	2.51	0.30		0.29	1.65		5.29	9
DN32	DN25	mm	25.40	20.50	108.00	41.30	42.70	60.20	84.10	130.15	187.00	71.70	7.54	7/16 UNF	7.40 (F04)	42.00	M5X10	4.00	16
1 1/4"	1"	inch	1.00	0.81	4.25	1.62	1.68	2.37	3.31	5.13	7.36	2.82	0.30		0.29	1.65		8.82	19
DN40	DN32	mm	31.80	26.60	115.50	48.40	43.60	73.00	97.00	139.05	237.00	86.70	8.71	9/16 UNF	8.50 (F05)	50.00	M6X12	5.50	40
1 1/2"	1 1/4"	inch	1.25	1.05	4.55	1.91	1.72	2.87	3.82	5.47	9.33	3.41	0.34		0.33	1.97		12.12	46
DN50	DN40	mm	38.10	35.00	128.00	56.30	48.30	77.80	101.80	149.45	237.00	96.90	8.71	9/16 UNF	8.50 (F05)	50.00	M6X12	6.90	42
2"	1 1/2"	inch	1.50	1.38	5.04	2.22	1.90	3.06	4.01	5.88	9.33	3.82	0.34		0.33	1.97		15.21	49
DN65	DN50	mm	50.80	48.00	158.00	72.60	70.00	88.10	115.10	175.40	237.00	108.00	8.71	9/16 UNF	13.50 (F07)	70.00	M8X12	14.45	96
2 1/2"	2"	inch	2.00	1.89	6.22	2.86	2.76	3.47	4.53	6.90	9.33	4.25	0.34		0.53	2.76		31.85	111



Side Entry Floating Ball 3 Piece

Components & materials

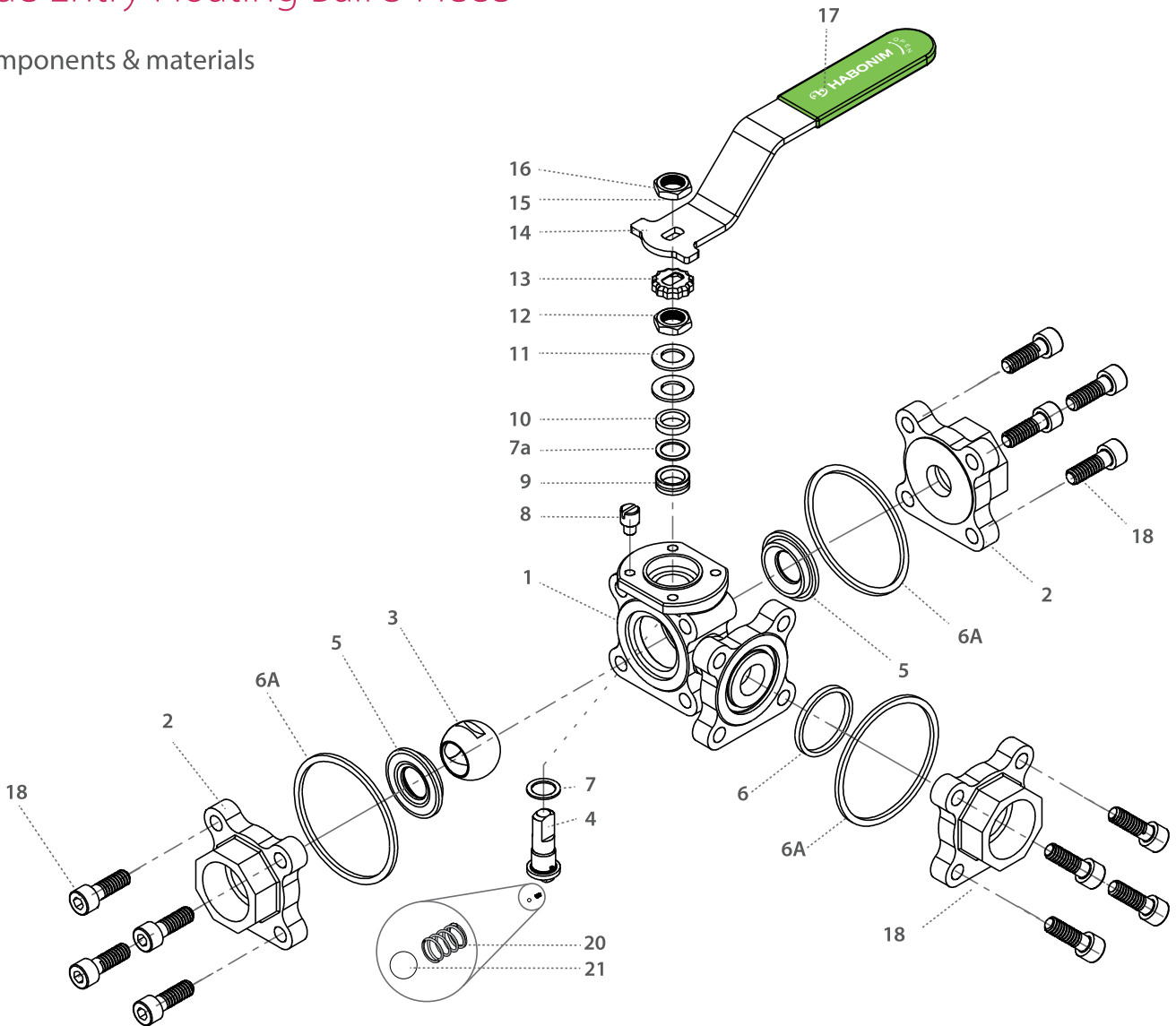

Item	Description	Material specification	Qty.
1	Body	Acc. Ordering Code	1
2	Ends	Acc. Ordering Code	3
3	Ball	Acc. Ordering Code	1
4	Stem	Acc. Ordering Code	1
5*	Seat	Acc. Ordering Code	2
6*	Body seal ⁽²⁾	Acc. Ordering Code	1
6A	Outer seal	Acc. Ordering Code	2
7*	Stem thrust seal	PEEK, CF PEEK, PCTFE	1
7a	Anti-abrasion ring	PEEK, CF PEEK, PCTFE	1
8	Stop pin	S. Steel	1
9*	Stem seal	CF PTFE, TFM	1
10	Follower	S. Steel	1

Item	Description	Material specification	Qty.
11	Disc spring	S. Steel	2
12	Stem nut	S. Steel	1
13	Locking clip	S. Steel	1
14	Handle	S. Steel	1
15	Serrated washer	S. Steel	1
16	Handle nut	S. Steel	1
17	Sleeve	PVC	1
18	Body bolt	S. Steel	4
20	Anti-static spring	S. Steel	1
21	Anti-static plunger	S. Steel	1
23	Tag (not shown)	S. Steel	1

* Repair kit components

⁽¹⁾ This material is available as standard as Seat-Seal one piece construction, No seal code required
⁽²⁾ One body seal is used in case of Seat-Seal one piece construction (Item #5), otherwise three body seals are used

Side Entry Floating Ball 3 Piece

Valve dimensions

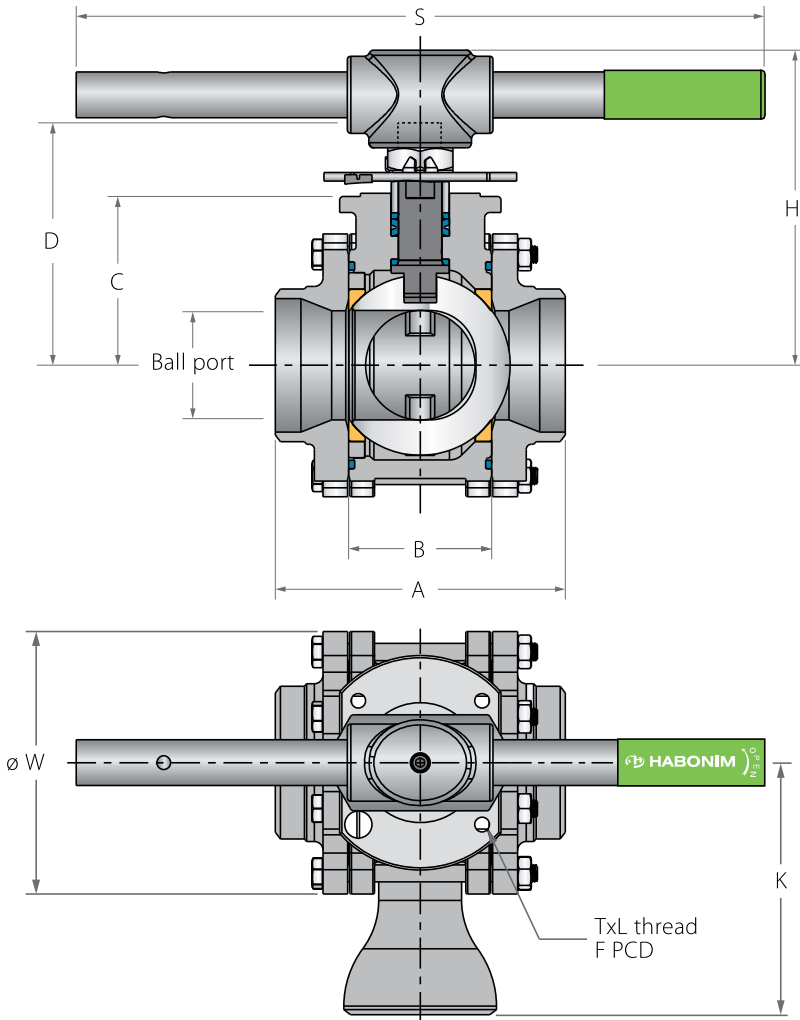

Preparation for actuation

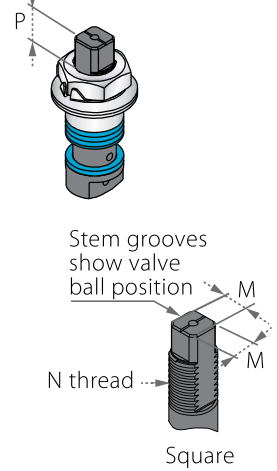

Std. port	Full port	Unit	Ball port 1	Ball port 2	A	B	C	D	H	K	S	W	M	N	P	F	TxL	Weight kg/lb	Kv Cv
DN80	DN65	mm	63.75	80.50	169	83.3	98.3	144.9	185	163	400	140.00	18.90	1"-14	16.70 (F10)	102.00	M10x20	18.00	129
3"	2½"	inch	2.51	3.17	6.65	3.28	3.87	5.70	7.28	6.42	15.75	5.50	0.74	UNS-2A	0.66	4.02	M10x20	39.67	150
DN100	DN80	mm	80.00	63.25	214	108.8	114.1	160.7	200	183	600	177.00	18.90	1"-14	16.70 (F10)	102.00	M10x20	28.20	182
4"	3"	inch	3.15	2.49	8.43	4.28	4.49	6.33	7.87	7.20	23.62	6.97	0.74	UNS-2A	0.66	4.02	M10x20	62.15	211
	DN100	mm	92.00	67.00	239	123	124	170.5	211	200	600	217.00	18.90	1"-14	16.70 (F10)	102.00	M10x20	36.00	334
	4"	inch	3.62	2.64	9.41	4.84	4.88	6.71	8.31	7.87	23.62	8.54	0.74	UNS-2A	0.66	4.02	M10x20	79.34	388
DN150		mm	111.35	77.90	346	146	157	226	286	212	916	266.00	28.45	1½"-12	26.20 (F12)	125.00	M12x20	41.00	437
6"		inch	4.38	3.07	13.62	5.75	6.18	8.90	11.26	8.35	36.06	10.47	1.12	UNF-2A	1.03	4.92	M12x20	90.36	507



Side Entry Floating Ball 3 Piece

Components & materials

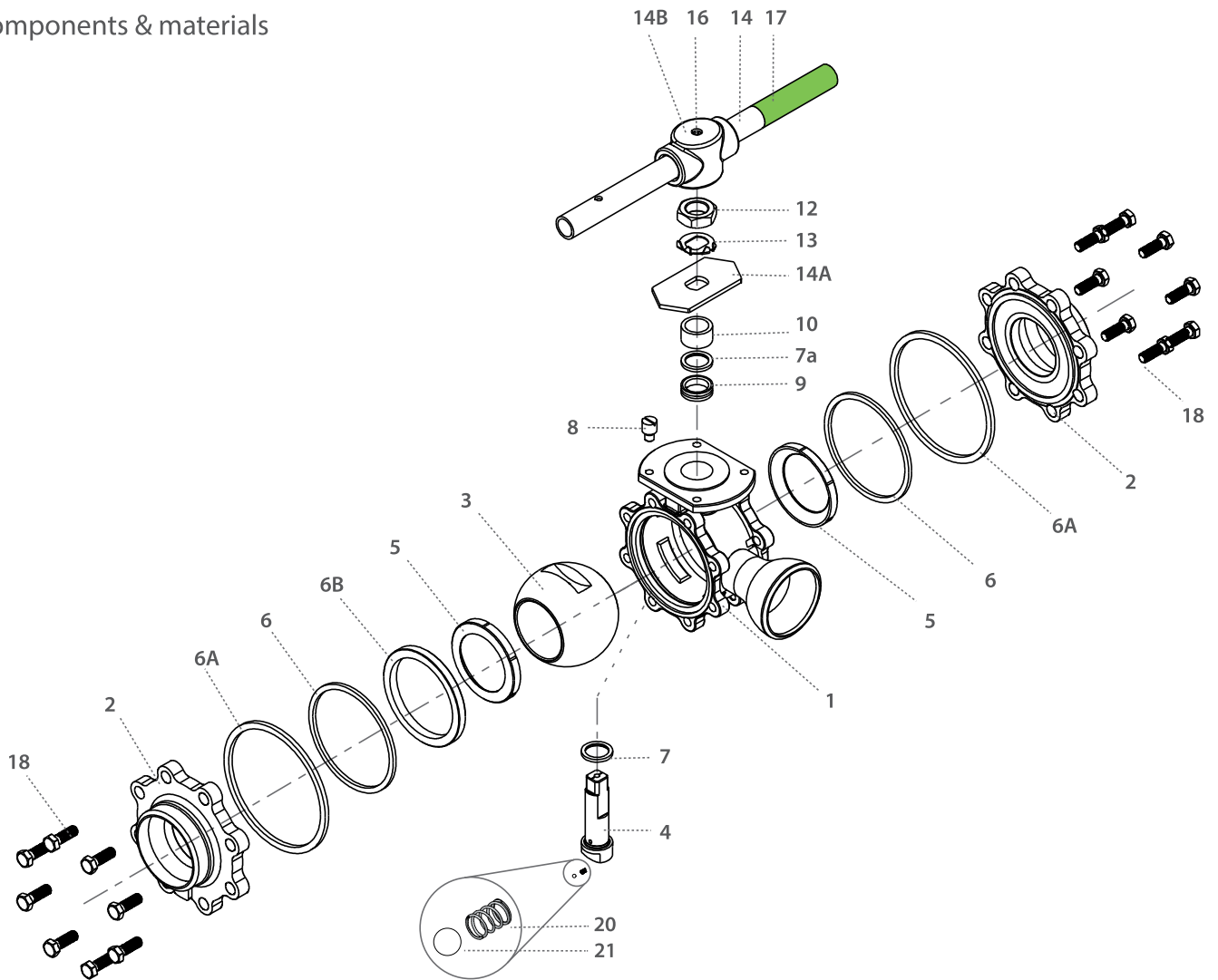

Item	Description	Material specification	Qty.
1	Body	Acc. Ordering Code	1
2	Plug	Acc. Ordering Code	1
3	Ball	Acc. Ordering Code	1
4	Stem	Acc. Ordering Code	1
5*	Seat	Acc. Ordering Code	2
6*	Body seal	Acc. Ordering Code	1
6A	Outer seal	Acc. Ordering Code	
6B	Support ring	Acc. Ordering Code	
7*	Stem thrust seal	PEEK, CF PEEK, PCTFE (KEL-F)	1
7a	Anti-abrasion ring	PEEK, CF PEEK, PCTFE (KEL-F)	1
8	Stop pin	Acc. Ordering Code	1
9*	Stem seal	CF PTFE, TFM, Graphite	1
10	Follower	S. Steel	1

Item	Description	Material specification	Qty.
11	Disc spring	S. Steel	2
12	Stem nut	S. Steel	1
13	Tab lock washer	S. Steel	1
14	Handle	S. Steel	1
14A	Stop plate	S. Steel	1
14B	Wrench head	S. Steel	1
16	Wrench bolt	S. Steel	1
17	Sleeve	PVC	1
20	Antistatic spring	S. Steel	2
21	Antistatic plunger	S. Steel	2
23	Tag (not shown)	S. Steel	1

* Repair kit components

D47

S47

Diverter | Side Entry 3 Piece - Ordering Code System

"Mandatory option" options are marked with **green background** | "Standard offer" options are marked with **light green background**

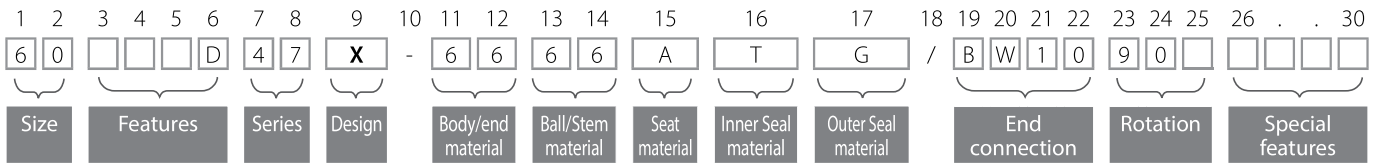

Size (1-2)		
Code	inch	mm
02	¼"	8
03	⅜"	10
05	½"	15
07	¾"	20
10	1"	25
12	1¼"	32
15	1½"	40
20	2"	50
25	2½"	65
30	3"	80
40	4"	100
60	6"	150
80	8"	200

Features (3-6)	
D	Diverter bottom entry
B	Full port
O	Clean assembly for O2 service
K	Chlorine service
F	Shell only - fire safe

Series (7-8)	
D47	3 piece bottom entry
S47	3 piece side entry

Design (9)	
X	HermetiX

Body/Ends material (11-12)	
6	S. SteelCF8M/CF3M
1	Bronze
4	C. steel A216 WCB/A105
9	C. steel A352 LCB
7	Monel
A	Alloy-20 A351 CN7M
W	Alloy-C22 B574
D	Duplex A479
K	Super Duplex A479
S	254SMO A479

Ball material (13)	
6	S. SteelCF8M/CF3M
W	Hasteloy-C22
S	254SMO
D	Duplex
1	Bronze
K	Super Duplex
7	Monel
A	Alloy-20
C	Hasteloy-C276

Stem material (14)	
6	S. Steel316L
M	High Strength S. Steel
Z	Inconel 718 B637
W	Alloy-C22 B574
S	254SMO A479
A	Alloy-20 A351 CN7M
D	Duplex A479
K	Super Duplex A479
7	Monel
C	Hasteloy-C276

Seat material (15)	
A	TFM(3)
U	UHMWPE
T	PTFE(3)
P	CF PTFE(3)
C	PCTFE
K	CF PEEK
L	Virgin Peek
Y	Delrin
W	PVDF

Inner Seal Material (16)	
T	PTFE
A	TFM
U	UHMWPE
V	Viton
B	NBR
G	Expanded graphite

Outer Seal Material (17)	
G	Expanded graphite
T	PTFE
A	TFM
U	UHMWPE
V	Viton
B	NBR

End Connection (19-22)	
Welded ends	
BW10	Buttweld schd. 10
BW	Buttweld schd. 40
SW	Socket weld
XBW10	Extended buttweld schd. 10
XBW	Extended buttweld schd. 40
XSW	Extended socket weld
BW5	Buttweld schd. 5
BW80	Buttweld schd. 80
BWO	Buttweld tube OD
BWD	Buttweld DIN 11850
BWI	buttweld ISO
SWO	Socket weld tube OD
ETO	Extended tube OD
ETI	Extended buttweld ISO
ETD	Extended buttweld DIN

Threaded	
NPT	ASME B1.20.1 - National Pipe Taper thread
BSPT	EN 10226 - Pipe Taper thread
BSPP	ISO228-1, DIN3852 - Pipe Parallel thread
DIN3852	DIN3852 - Pipe Parallel thread
AS5202	SAE internal straight thread
MNPT	Male NPT
MBSPT	Male BSPT

Flanged	
150	ASME B16.5 #150 RF
300	ASME B16.5 #300 RF
600	ASME B16.5 #600 RF
900	ASME B16.5 #900 RF
PN16	EN1092 PN16 RF
PN40	EN1092 PN40 RF
PN64	EN1092 PN64 RF
PN100	EN1092 PN100 RF
PN160	EN1092 PN160 RF

Clamp	
LL	Compression fitting (Imperial)
LM	Compression fitting (metric)
TC	Tri-Clamp
GR	Grayloc® compatible hub (Grayloc® is a registered trademark of Grayloc Products, L.L.C.)

Rotation (23 -25)	
90	90 degrees rotation
180	180 degrees rotation applicable for bottom entry diverter valve L

Special Features (24-30)	
B	Body made from rolled bar
EP	Electropolished
WR	DD stem
G...	Internal surface finish (G24, G32)

Valve Special Stem Seals	
AAX	FDA compliant stem seal. TFM thrust bearing and X shape gasket
PPX	CF PTFE thrust and X shape gasket
CAX	PCTFE thrust and TFM X shape gasket
CPX	PCTFE thrust and CF PTFE X shape gasket
HC	High Cycle service
HYD	Hydrogen

D31

S31

D32

S32



General Use Industrial

FLOATING BALL

DIVERTER
SIDE ENTRY FLANGED

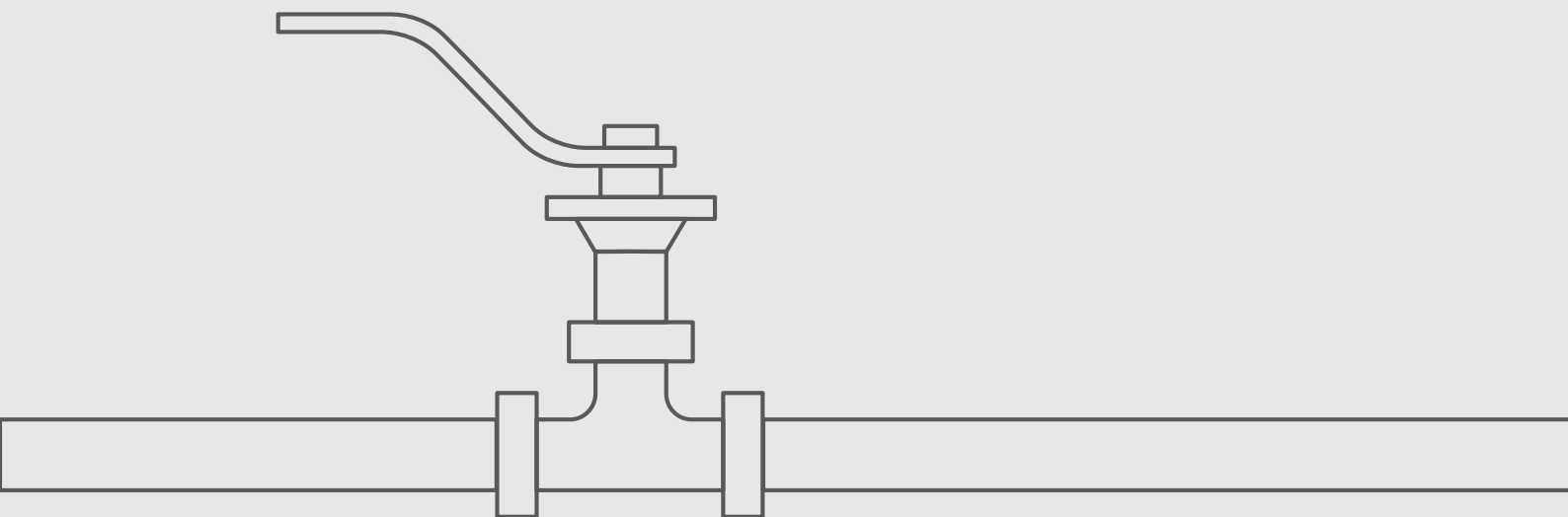





Side Entry - S31, S32

Rotation: 90°

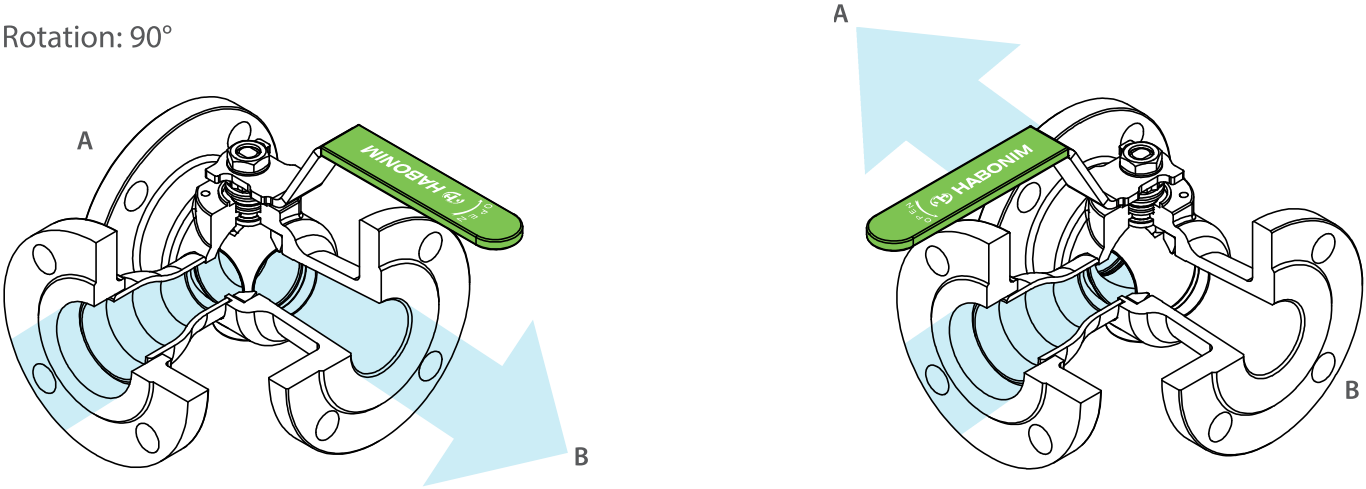

Bottom Entry - D31, D32

Rotation: 90°

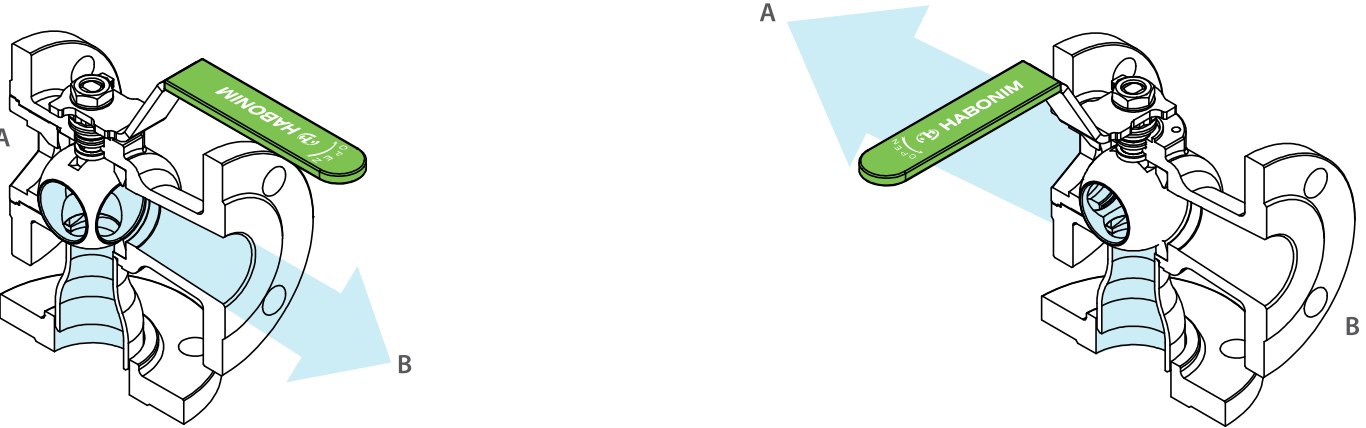

Bottom Entry - D31, D32

Rotation: 180°

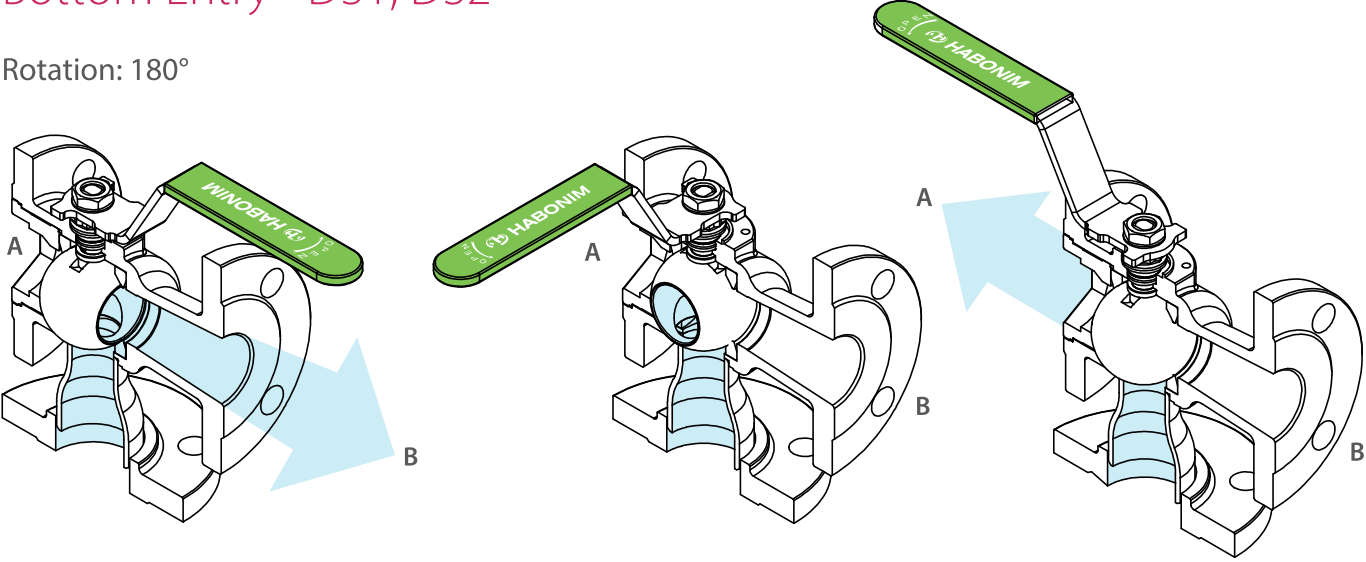

D31

D32

1/2"-2" | DN15-DN50 | CLASS 150/300

Diverter Floating Ball Flanged

Valve dimensions

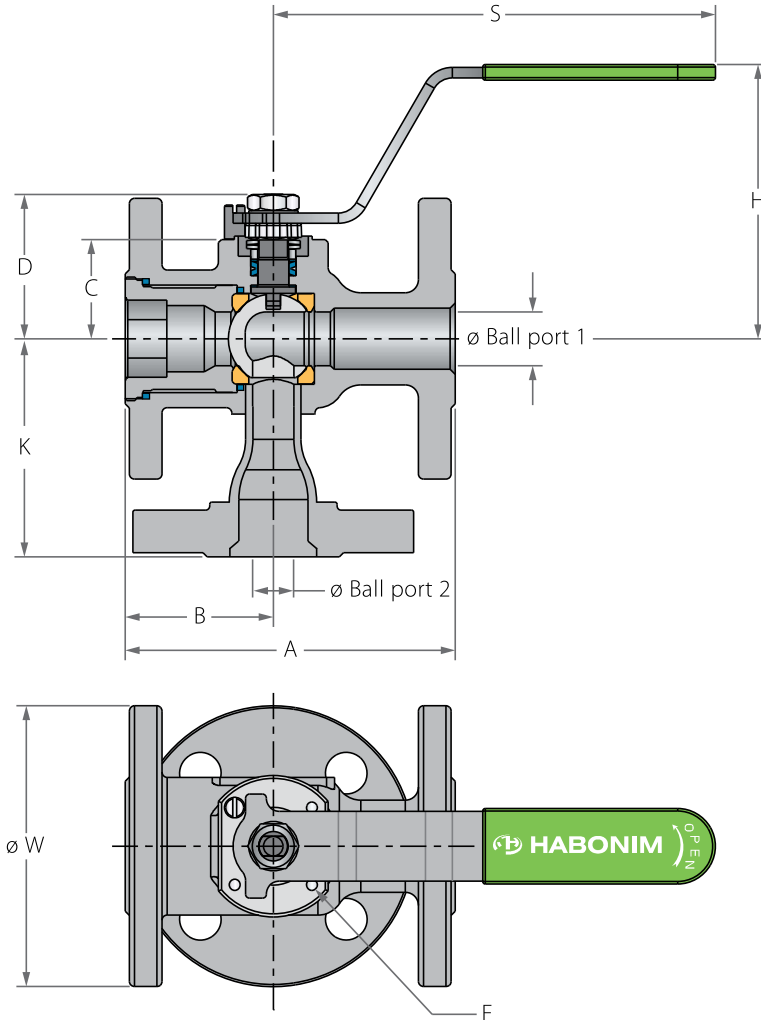

Preparation for actuation

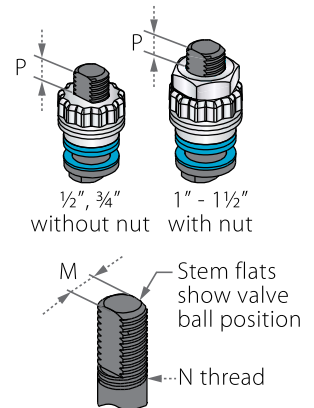

Std. port	Unit	Ball port1	Ball port2	A		B	C	D	H	K	S	W		M	N	P	F	Weight kg/lb		Kv
				150	300							150	300					150	300	
DN15	mm	13.50	11.15	108.00	140.00	46.00	29.00	38.00	92.00	70.00	151.00	88.90	95.25	5.54	3/8	6.65 (F03)	36.00	1.7	2.4	2.8
1/2"	inch	0.53	0.44	4.25	5.50	1.81	1.14	1.50	3.62	2.76	5.94	3.50	3.75	0.22	UNF	0.26	1.42	3.8	5.3	3.3
DN20	mm	17.50	14.30	117.00	152.00	49.00	31.40	40.30	94.00	85.00	151.00	98.55	163.07	5.54	3/8	6.65 (F03)	36.00	2.3	3.3	4
3/4"	inch	0.69	0.56	4.61	6.00	1.93	1.24	1.59	3.70	3.35	5.94	3.88	6.42	0.22	UNF	0.26	1.42	5.1	7.3	5
DN25	mm	23.50	20.60	127.00	165.00	57.00	38.20	55.60	103.50	90.00	170.00	107.95	123.95	7.54	7/16	7.40 (F04)	42.00	3.1	4.6	8
1"	inch	0.93	0.81	5.00	6.50	2.25	1.50	2.19	4.07	3.54	6.69	4.25	4.88	0.30	UNF	0.29	1.65	7.3	10.2	9
DN40	mm	39.00	31.80	165.00	190.00	62.00	43.60	73.10	119.20	110.00	220.50	127.00	155.52	8.71	9/16	8.50 (F05)	50.00	5.5	8.7	40
1 1/2"	inch	1.54	1.25	6.50	7.50	2.44	1.72	2.88	4.70	4.33	8.68	5.00	6.10	0.34	UNF	0.33	1.97	12.2	19.3	46
DN50	mm	48.00	38.20	178.00	216.00	68.00	48.30	77.80	123.90	130.00	220.50	152.40	165.10	8.71	9/16	8.50 (F05)	50.00	8.1	10.8	42
2"	inch	1.89	1.50	7.00	8.50	2.67	1.90	3.06	4.88	5.12	8.68	6.00	6.50	0.34	UNF	0.33	1.97	18	24	49

D31

D32

1/2"-2" | DN15-DN50 | CLASS 150/300



Diverter Floating Ball Flanged

Components & materials

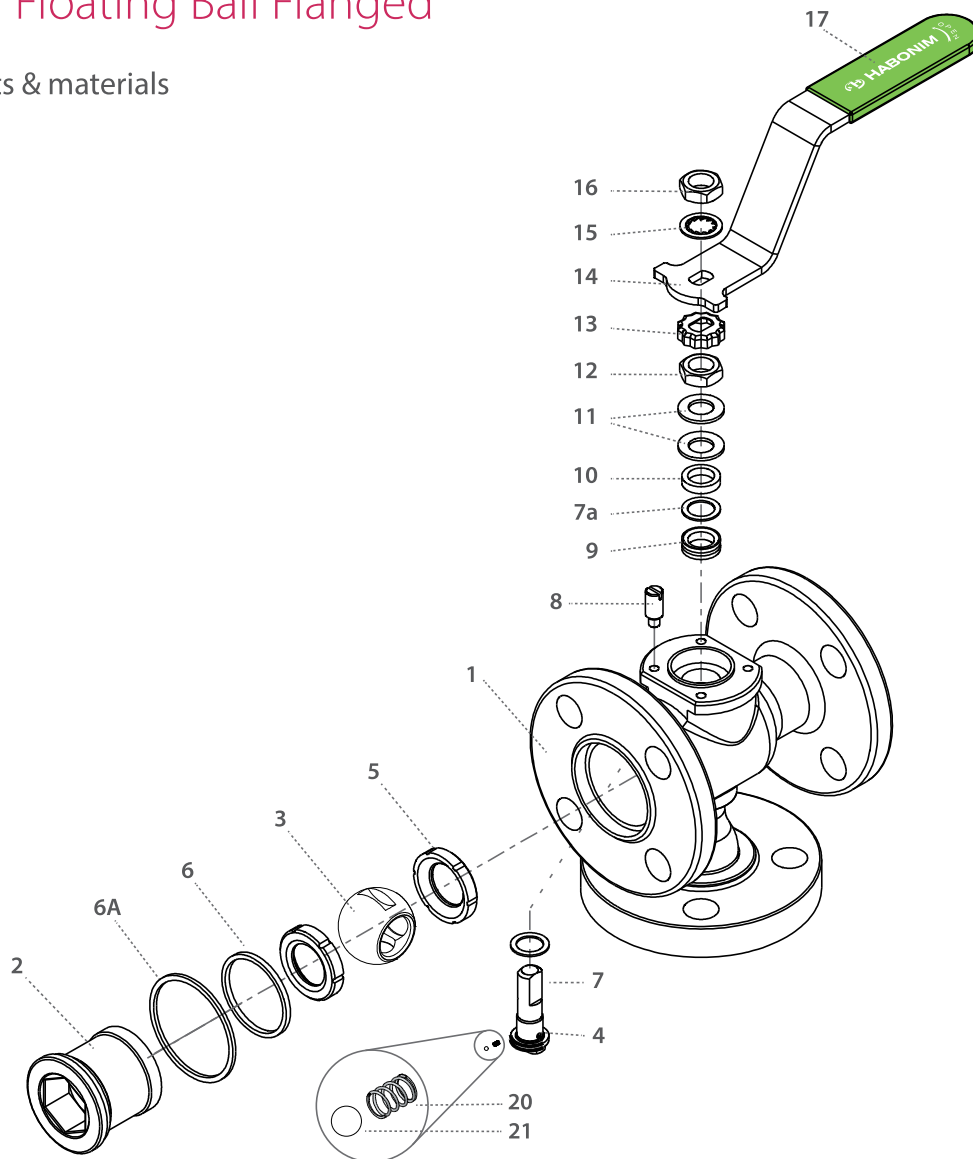

Item	Description	Material specification	Qty.
1	Body	Acc. Ordering Code	1
2	Plug	Acc. Ordering Code	1
3	Ball	Acc. Ordering Code	1
4	Stem	Acc. Ordering Code	1
5*	Seat	Acc. Ordering Code	2
6*	Inner seal	PTFE	1
6A	Outer seal	Acc. Ordering Code	
7*	Stem thrust seal	PEEK, CF PEEK, PCTFE (KEL-F)	1
7a	Anti-abrasion ring	PEEK, CF PEEK, PCTFE (KEL-F)	1
8	Stop pin	S. Steel	1
9*	Stem seal	CF PTFE, TFM, Graphite ⁽²⁾	1
10	Follower	S. Steel	1

Item	Description	Material specification	Qty.
11	Disc spring	S. Steel	2
12	Stem nut	S. Steel	1
13	Locking clip	S. Steel	1
14	Handle	S. Steel	1
15	Serrated washer	S. Steel	1
16	Handle nut	S. Steel	1
17	Sleeve	PVC	1
20	Anti-static spring	S. Steel	1
21	Anti-static plunger	S. Steel	1
23	Tag (not shown)	S. Steel	1

* Repair kit components

D31

D32

3"-8" | DN80-DN200 | CLASS 150/300

Diverter Floating Ball Flanged

Valve dimensions

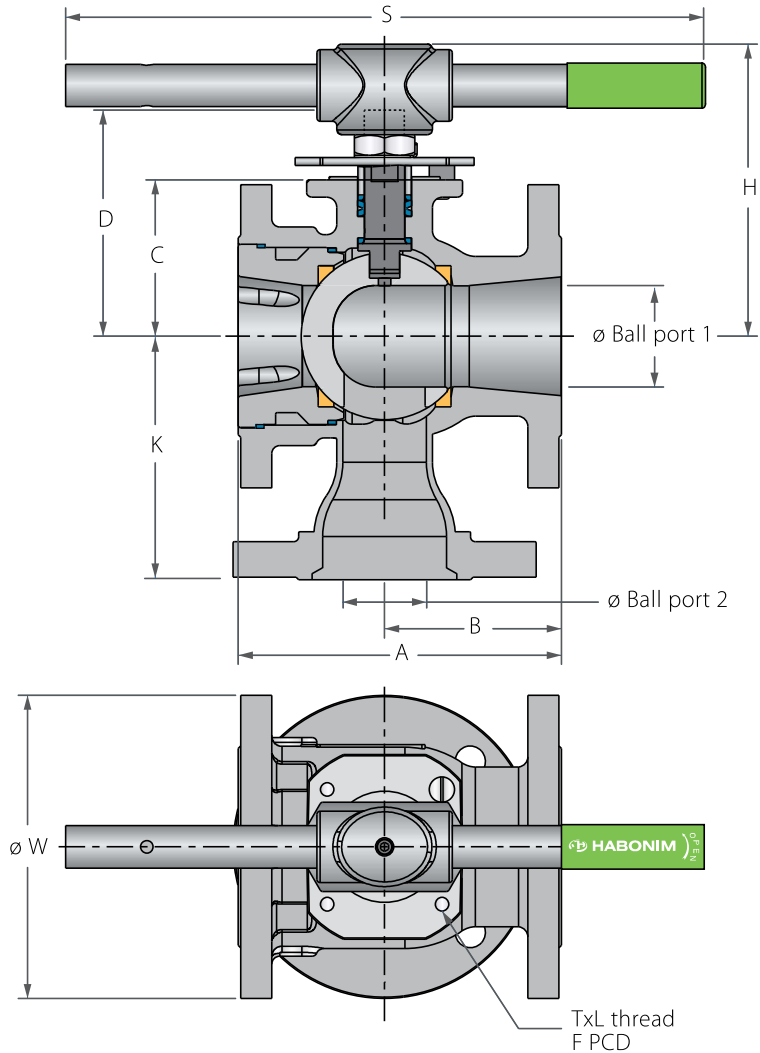

Preparation for actuation

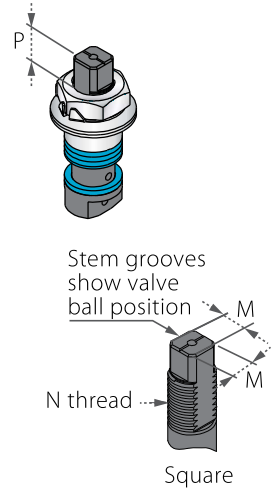

Std. port	Unit	Ball port1	Ball port2	A		B	C	D	H	K	S	W		M	M-DD	N	P	F	TxL	Weight kg/lb		Kv
				150	300							150	300							150	300	
DN80	mm	63.50	50.00	203.00	284.00	92.00	98.40	145.00	185.10	153.00	400.00	190.50	209.55	18.90	15.90	1"-14	16.70 (F10)	102.00	M10x20	18.00	22.70	129
3"	inch	2.50	1.97	8.00	11.18	3.62	3.88	5.72	7.28	6.02	15.75	7.50	8.25	0.74	0.63	UNS-2A	0.66	4.02	M10x20	40.00	50.40	150
DN100	mm	82.60	63.00	229.00	305.00	102.00	114.10	161.00	201.00	185.00	610.00	228.60	254.00	18.90	15.90	1"-14	16.70 (F10)	102.00	M10x20	28.20	36.30	182
4"	inch	3.25	2.48	9.00	12.00	4.00	4.49	6.34	7.91	7.28	24.01	9.00	10.00	0.74	0.63	UNS-2A	0.66	4.02	M10x20	62.80	80.60	211
DN150	mm	111.10	78.00	267.00	403.20	108.00	157.40	226.00	285.90	250.00	916.00	279.40	317.50	28.45	23.75	1 1/2"-12	26.20 (F12)	125.00	M12x20	41.00	69.00	437
6"	inch	4.38	3.07	10.50	15.88	4.25	6.20	8.91	11.25	9.84	36.08	11.00	12.50	1.12	0.94	UNF-2A	1.03	4.92	M12x20	91.00	153.00	507
DN200	mm	144.40	98.00	292.00	419.00	163.50	185.20	254.00	313.60	300.00	916.00	342.90	381.00	28.45	23.75	1 1/2"-12	26.20 (F12)	125.00	M12x20	82.00	105.00	698
8"	inch	5.68	3.86	11.50	16.50	5.37	7.30	10.00	12.34	11.81	36.08	13.50	15.00	1.12	0.94	UNF-2A	1.03	4.92	M12x20	182.00	233.00	810



Diverter Floating Ball Flanged

Components & materials

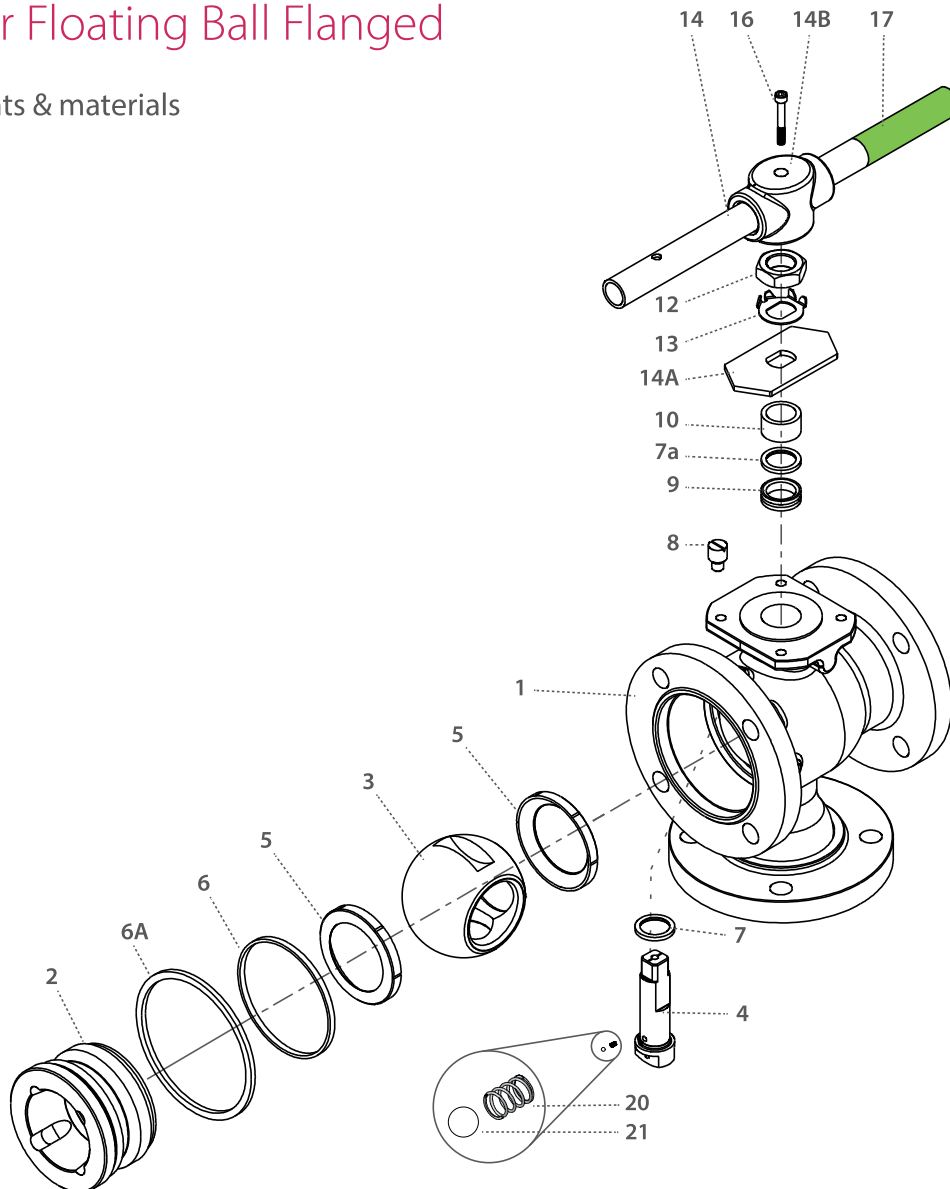

Item	Description	Material specification	Qty.
1	Body	Acc. Ordering Code	1
2	Plug	Acc. Ordering Code	1
3	Ball	Acc. Ordering Code	1
4	Stem	Acc. Ordering Code	1
5*	Seat	Acc. Ordering Code	2
6*	Body seal	PTFE	1
6A	Outer seal	Acc. Ordering Code	
7*	Stem thrust seal	PEEK, CF PEEK, PCTFE (KEL-F)	1
7a	Anti-abrasion ring	PEEK, CF PEEK, PCTFE (KEL-F)	1
8	Stop pin	S. Steel	1
9*	Stem seal	CF PTFE, TFM, Graphite ⁽¹⁾	1
10	Follower	S. Steel	1

Item	Description	Material specification	Qty.
11	Disc spring	S. Steel	2
12	Stem nut	S. Steel	1
13	Tab lock washer	S. Steel	1
14	Handle	S. Steel	1
14A	Stop plate	S. Steel	1
14B	Wrench head	S. Steel	1
16	Wrench bolt	S. Steel	1
17	Sleeve	PVC	1
20	Anti-static spring	S. Steel	2
21	Anti-static plunger	S. Steel	2
23	Tag (not shown)	S. Steel	1

* Repair kit components

⁽¹⁾ This material can only be used as part of the D31/D32 design.

S31

S32

1/2"-2" | DN15-DN50 | CLASS 150/300

Side Entry Floating Ball Flanged

Valve dimensions

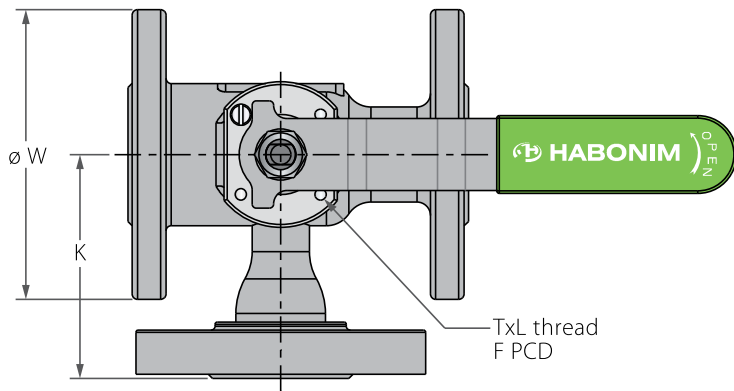
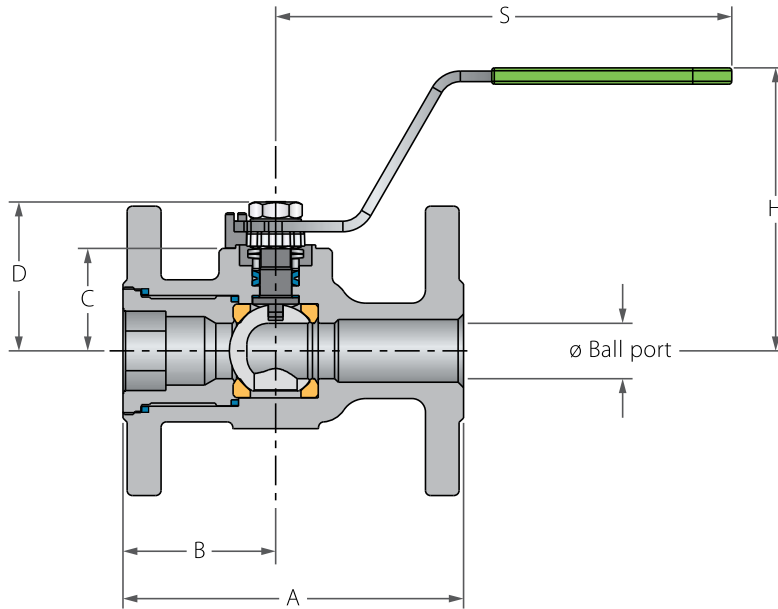

Preparation for actuation

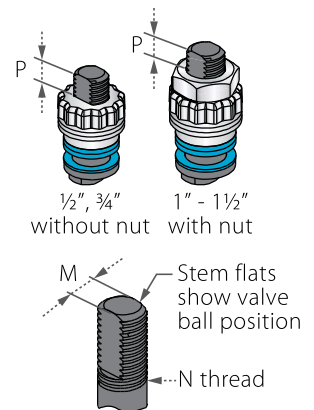

Std. port	Unit	Ball port1	Ball port2	A		B	C	D	H	K	S	W		M	N	P	F	Weight kg/lb			Kv
				150	300							150	300					150	300	Cv	
DN15	mm	13.50	11.15	108.00	140.00	46.00	29.00	38.00	92.00	70.00	151.00	88.90	95.25	5.54	3/8	6.65 (F03)	36.00	1.7	2.4	2.8	
1/2"	inch	0.53	0.44	4.25	5.50	1.81	1.14	1.50	3.62	2.76	5.94	3.50	3.75	0.22	UNF	0.26	1.42	3.8	5.3	3.3	
DN20	mm	17.50	14.30	117.00	152.00	49.00	31.40	40.30	94.00	85.00	151.00	98.55	163.07	5.54	3/8	6.65 (F03)	36.00	2.3	3.3	4	
3/4"	inch	0.69	0.56	4.61	6.00	1.93	1.24	1.59	3.70	3.35	5.94	3.88	6.42	0.22	UNF	0.26	1.42	5.1	7.3	5	
DN25	mm	23.50	20.60	127.00	165.00	57.00	38.20	55.60	103.50	90.00	170.00	107.95	123.95	7.54	7/16	7.40 (F04)	42.00	3.1	4.6	8	
1"	inch	0.93	0.81	5.00	6.50	2.25	1.50	2.19	4.07	3.54	6.69	4.25	4.88	0.30	UNF	0.29	1.65	7.3	10.2	9	
DN40	mm	39.00	31.80	165.00	190.00	62.00	43.60	73.10	119.20	110.00	220.50	127.00	155.52	8.71	9/16	8.50 (F05)	50.00	5.5	8.7	40	
1 1/2"	inch	1.54	1.25	6.50	7.50	2.44	1.72	2.88	4.70	4.33	8.68	5.00	6.10	0.34	UNF	0.33	1.97	12.2	19.3	46	
DN50	mm	48.00	38.20	178.00	216.00	68.00	48.30	77.80	123.90	130.00	220.50	152.40	165.10	8.71	9/16	8.50 (F05)	50.00	8.1	10.8	42	
2"	inch	1.89	1.50	7.00	8.50	2.67	1.90	3.06	4.88	5.12	8.68	6.00	6.50	0.34	UNF	0.33	1.97	18	24	49	



Side Entry Floating Ball Flanged

Components & materials

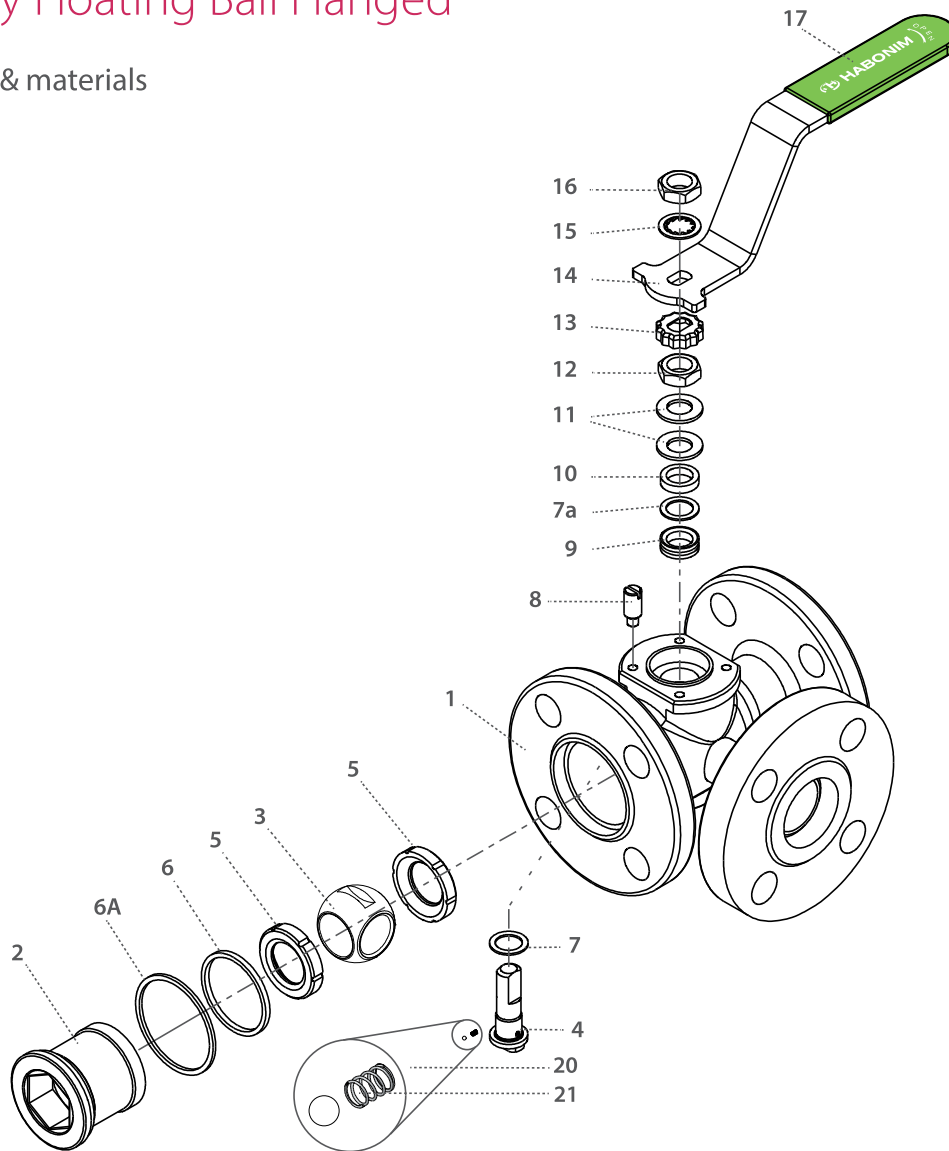

Item	Description	Material specification	Qty.
1	Body	Acc. Ordering Code	1
2	Plug	Acc. Ordering Code	1
3	Ball	Acc. Ordering Code	1
4	Stem	Acc. Ordering Code	1
5*	Seat	Acc. Ordering Code	2
6*	Body seal	PTFE	1
6A	Outer seal	Acc. Ordering Code	1
7*	Stem thrust seal	PEEK, CF PEEK, PCTFE (KEL-F)	1
7a	Anti-abrasion ring	PEEK, CF PEEK, PCTFE (KEL-F)	1
8	Stop pin	S. Steel	1
9*	Stem seal	CF PTFE, TFM, Graphite ⁽¹⁾	1
10	Follower	S. Steel	1

⁽¹⁾ This material can only be used as part of the S31/S32 design.

Item	Description	Material specification	Qty.
11	Disc spring	S. Steel	2
12	Stem nut	S. Steel	1
13	Locking clip	S. Steel	1
14	Handle	S. Steel	1
15	Serrated washer	S. Steel	1
16	Handle nut	S. Steel	1
17	Sleeve	PVC	1
20	Anti-static spring	S. Steel	1
21	Anti-static plunger	S. Steel	1
23	Tag (not shown)	S. Steel	1

* Repair kit components

S31

S32

3"-8" | DN80-DN200 | CLASS 150/300

Side Entry Floating Ball Flanged

Valve dimensions

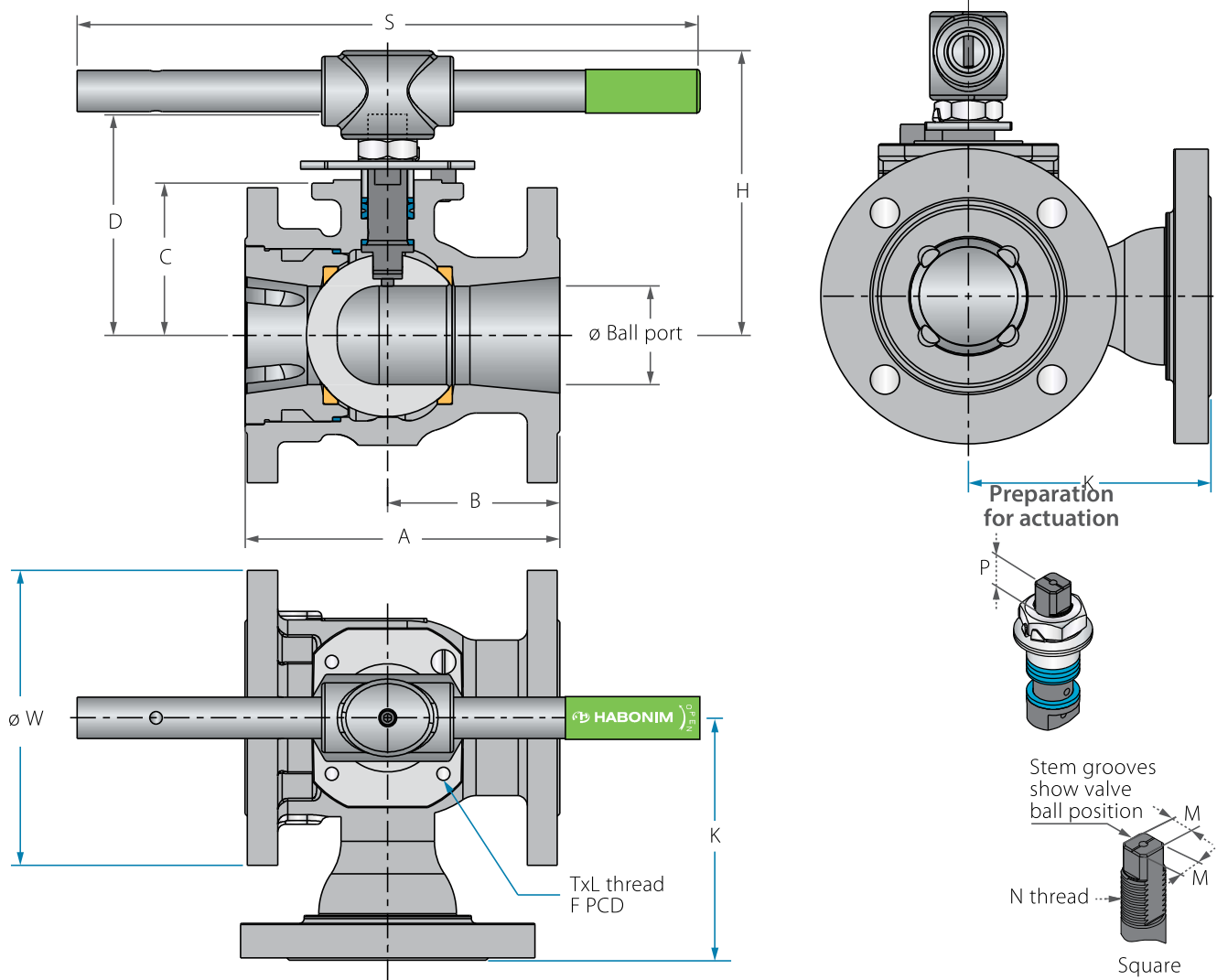

Std. port	Unit	Ball port1	Ball port2	A		B	C	D	H	K	S	W		M	M-DD	N	P	F	TxL	Weight kg/lb		Kv
				150	300							150	300							150	300	
DN80	mm	63.50	50.00	203.00	284.00	92.00	98.40	145.00	185.10	153.00	400.00	190.50	209.55	18.90	15.90	1"-14	16.70 (F10)	102.00	M10x20	18.00	22.70	129
3"	inch	2.50	1.97	8.00	11.18	3.62	3.88	5.72	7.28	6.02	15.75	7.50	8.25	0.74	0.63	UNS-2A	0.66	4.02	M10x20	40.00	50.40	150
DN100	mm	82.60	63.00	229.00	305.00	102.00	114.10	161.00	201.00	185.00	610.00	228.60	254.00	18.90	15.90	1"-14	16.70 (F10)	102.00	M10x20	28.20	36.30	182
4"	inch	3.25	2.48	9.00	12.00	4.00	4.49	6.34	7.91	7.28	24.01	9.00	10.00	0.74	0.63	UNS-2A	0.66	4.02	M10x20	62.80	80.60	211
DN150	mm	111.10	78.00	267.00	403.20	108.00	157.40	226.00	285.90	250.00	916.00	279.40	317.50	28.45	23.75	1½"-12	26.20 (F12)	125.00	M12x20	41.00	69.00	437
6"	inch	4.38	3.07	10.50	15.88	4.25	6.20	8.91	11.25	9.84	36.08	11.00	12.50	1.12	0.94	UNF-2A	1.03	4.92	M12x20	91.00	153.00	507
DN200	mm	144.40	98.00	292.00	419.00	163.50	185.20	254.00	313.60	300.00	916.00	342.90	381.00	28.45	23.75	1½"-12	26.20 (F12)	125.00	M12x20	82.00	105.00	698
8"	inch	5.68	3.86	11.50	16.50	5.37	7.30	10.00	12.34	11.81	36.08	13.50	15.00	1.12	0.94	UNF-2A	1.03	4.92	M12x20	182.00	233.00	810



Side Entry Floating Ball Flanged

Components & materials

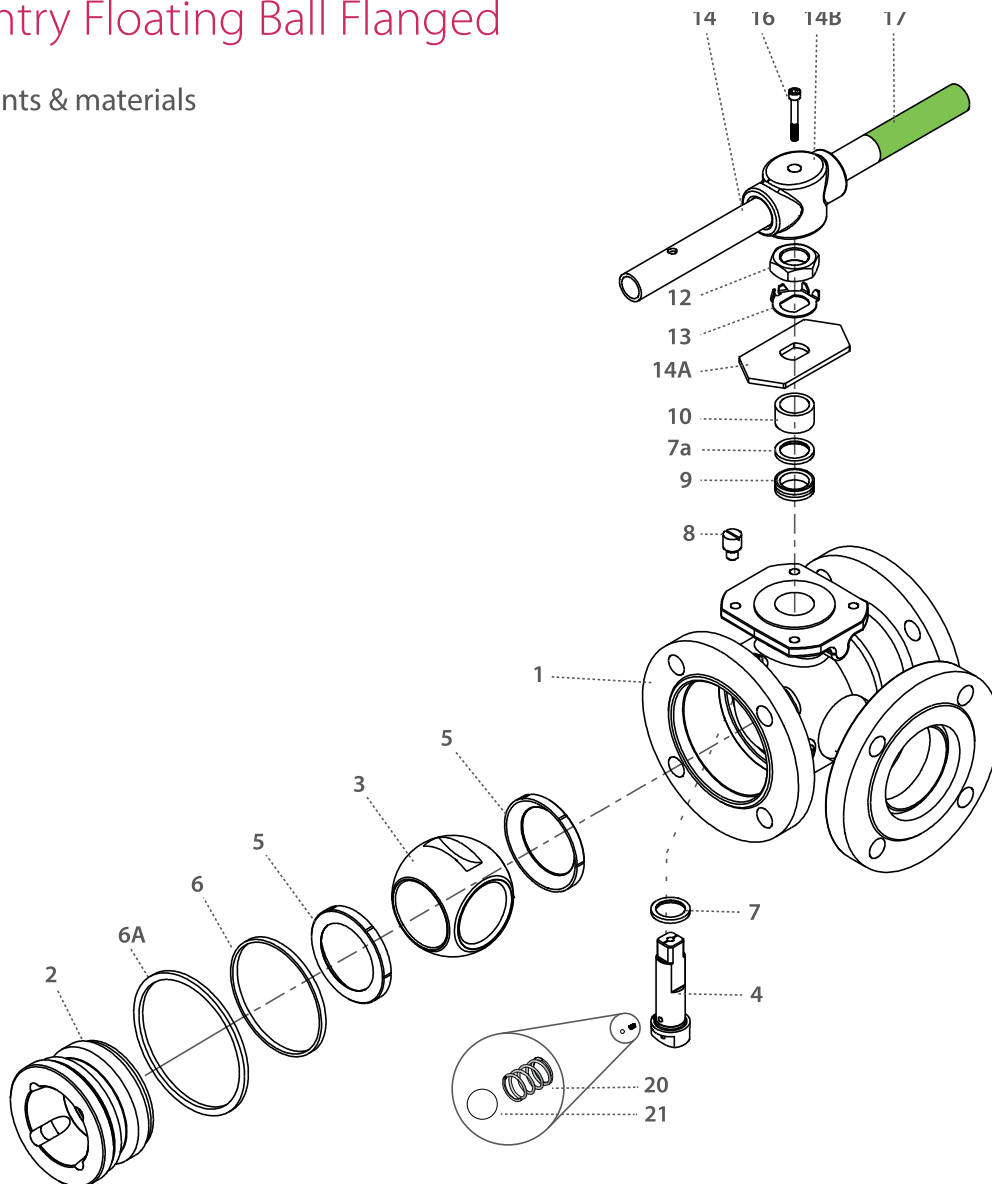

Item	Description	Material specification	Qty.
1	Body	Acc. Ordering Code	1
2	Plug	Acc. Ordering Code	1
3	Ball	Acc. Ordering Code	1
4	Stem	Acc. Ordering Code	1
5*	Seat	Acc. Ordering Code	2
6*	Body seal	PTFE	1
6A	Outer seal	Acc. Ordering Code	
7*	Stem thrust seal	PEEK, CF PEEK, PCTFE (KEL-F)	1
7a	Anti-abrasion ring	PEEK, CF PEEK, PCTFE (KEL-F)	1
8	Stop pin	S. Steel	1
9*	Stem seal	CF PTFE, TFM, Graphite ⁽¹⁾	1
10	Follower	S. Steel	1

⁽¹⁾ This material can only be used as part of the S31/S32 design.

Item	Description	Material specification	Qty.
11	Disc spring	S. Steel	2
12	Stem nut	S. Steel	1
13	Tab lock washer	S. Steel	1
14	Handle	S. Steel	1
14A	Stop plate	S. Steel	1
14B	Wrench head	S. Steel	1
16	Wrench bolt	S. Steel	1
17	Sleeve	PVC	1
20	Anti-static spring	S. Steel	2
21	Anti-static plunger	S. Steel	2
23	Tag (not shown)	S. Steel	1

* Repair kit components

D31

S31

D32

S32

Diverter I Side Entry Floating Ball Flanged - Ordering Code System

"Mandatory option" options are marked with **green background** | "Standard offer" options are marked with **light green background**

1	2	3	4	5	6	7	8	9	10	11	12	13	14	15	16	17	18	19	20	21	22	23	24	#	26	.	.	30
6	0				D	3	1	X	-	6	6	6	6	A	T	G	/	B	W	1	0	9	0					
Size		Features				Series		Design		Body/end material		Ball/Stem material		Seat material	Inner Seal material	Outer Seal material		End connection				Rotation		Special features				

Size (1-2)		
Code	inch	mm
05	½"	15
07	¾"	20
10	1"	25
15	1½"	40
20	2"	50
30	3"	80
40	4"	100
60	6"	150
80	8"	200

Features (3-6)	
D	Diverter bottom entry
O	Clean assembly for O2 service
Series (7-8)	
D31	ANSI #150 flanged bottom entry
S31	ANSI #150 flanged side entry
D32	ANSI #300 flanged bottom entry
D32	ANSI #300 flanged side entry
Design (9)	
X	HermetiX
Body/Ends material (11-12)	
6	S. SteelCF8M/CF3M
4	C. steel A216 WCB/A105
D	Duplex A479
K	Super Duplex A479
S	254SMO A479
Ball material (13)	
6	S. SteelCF8M/CF3M
M	High Strength S. Steel
S	254SMO
D	Duplex
K	Super Duplex

Stem material (14)	
6	S. Steel316L
M	High Strength S. Steel
Z	Inconel 718 B637
D	Duplex A479
K	Super Duplex A479
S	254SMO A479
Seat material (15)	
A	TFM
P	CF PTFE
K	CF PEEK
L	Virgin Peek
U	UHMWPE
C	PCTFE
Y	Delrin
W	PVDF
T	PTFE
Inner Seal Material (16)	
T	PTFE
A	TFM
G	Expanded graphite
U	UHMWPE
V	Viton
B	NBR
Outer Seal (17)	
G	Expanded graphite
T	PTFE
A	TFM
U	UHMWPE
V	Viton
B	NBR

End Connection (19-22)	
Flanged	
150	ASME B16.5 #150 RF
300	ASME B16.5 #300 RF
PN16	EN1092 PN16 RF
PN40	EN1092 PN40 RF
Rotation (23 -25)	
90	90 degrees rotation
180	180 degrees rotation applicable for bottom entry diverter valve L
Special Features (24-30)	
Valve Special Stem Seals	
HC	High Cycle service
AAX	FDA compliant stem seal. TFM thrust bearing and X shape gasket
PPX	CF PTFE thrust and X shape gasket
CAX	PCTFE thrust and TFM X shape gasket
CPX	PCTFE thrust and CF PTFE X shape gasket
HYD	Hydrogen